

Permanent
Lubrication
on the
Rod

Range chart

Model	Body Ø mm	Stroke Cu mm	Initial force daN			
				SKUDO	OSAS	OPAS
SC 150	32	10 - 125	170	-	✓	-
SC 250	38	10 - 125	260	-	✓	-
SCF 250	M 38 x 1,5	10 - 125	260	-	✓	-
SC 500	45	13 - 160	470	-	-	-
SCF 500	M 45 x 1,5	13 - 160	470	-	-	-
SC 750	50	13 - 300	740	-	-	-
SCF 750	M 50 x 1,5	13 - 300	740	-	-	-
SC 1500	75	25 - 300	1530	-	-	-
SC 3000	95	25 - 300	2945	-	-	-
SC 5000	120	25 - 300	4980	-	-	-
SC 7500	150	25 - 300	7540	-	-	-
SC 10000	195	25 - 300	10600	-	-	-

ISO 11901 Standard - ISO 11901 Standard - ISO 11901 Standard -
 Conforme ISO 11901 - ISO 11901 Standard - Norma ISO 11901

PED ISO 11901
 97/23/EC

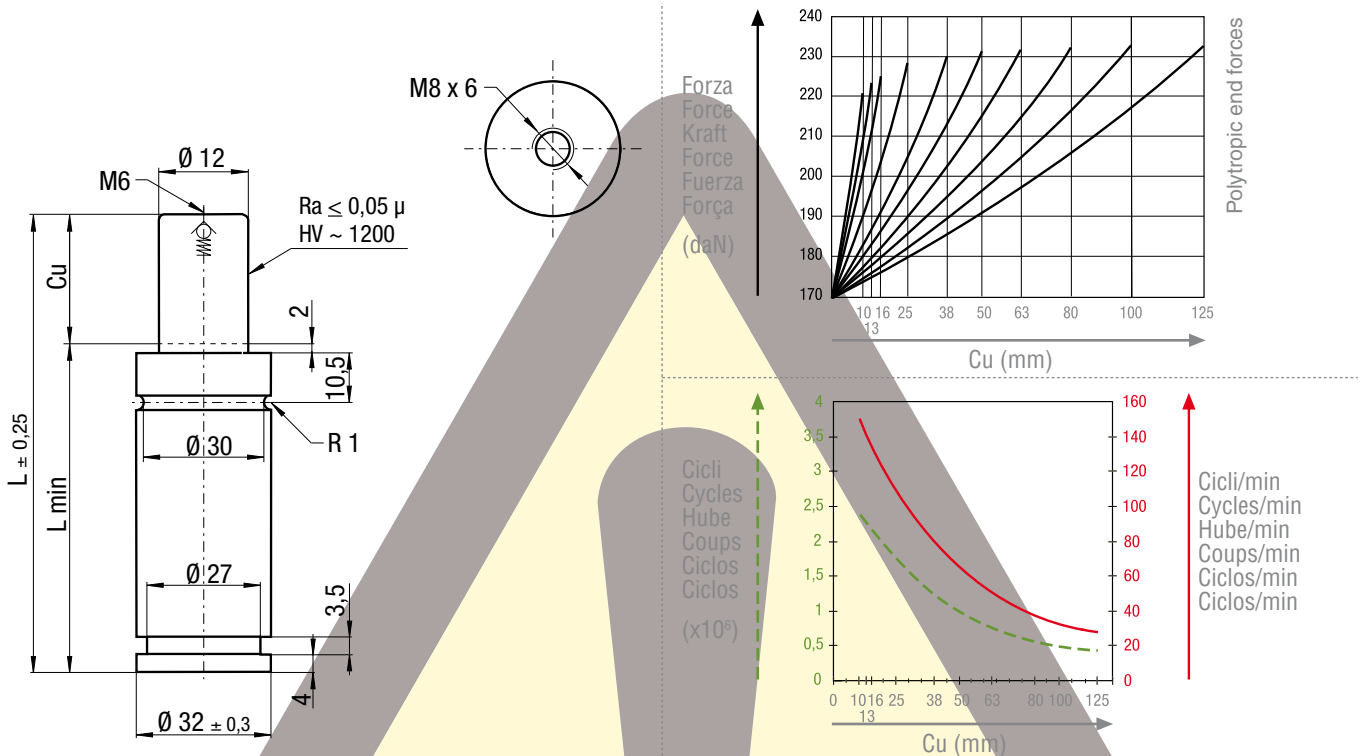

ORDER

(10) SC 150-050-B

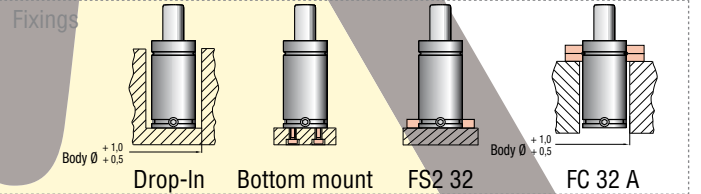

Max. Speed
 1,8 m/s

°F 32
 176
 °C 0
 80



P max
 150 bar
 2175 psi

P min
 20 bar
 290 psi

S
 1,13
 cm²



Maintenance kit
 39BMSC00150B

Technical specifications

Code	Cu mm	L mm	Lmin mm	Fo at 150 bar/+20 °C daN (±5%)	Vo cm ³		 Kg
SC 150 - 010 - B	10	70	60	170	-	-	~0,28
SC 150 - 013 - B	13	75,4	62,7	170	-	-	~0,29
SC 150 - 016 - B	16	82	66	170	-	-	~0,30
SC 150 - 025 - B	25	100	75	170	-	-	~0,33
SC 150 - 038 - B	38	126	88	170	-	-	~0,36
SC 150 - 050 - B	50	150	100	170	-	-	~0,40
SC 150 - 063 - B	63	177	113,5	170	-	-	~0,44
SC 150 - 080 - B	80	210	130	170	-	-	~0,49
SC 150 - 100 - B	100	250	150	170	-	-	~0,55
SC 150 - 125 - B	125	300	175	170	-	-	~0,64

SC 150

ISO 11901
VDI 3003
CNOMO E24.54815.N



ISO 11901 Standard - ISO 11901 Standard - ISO 11901 Standard -
Conforme ISO 11901 - ISO 11901 Standard - Norma ISO 11901

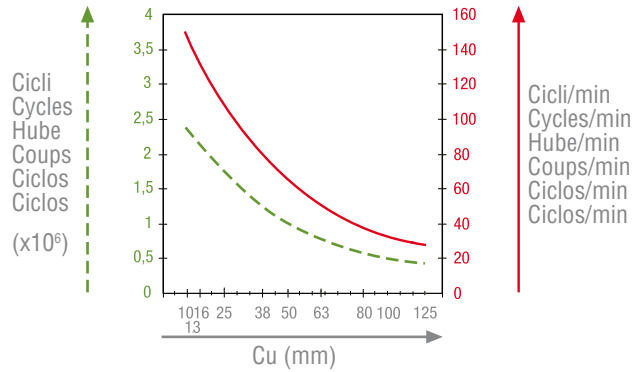
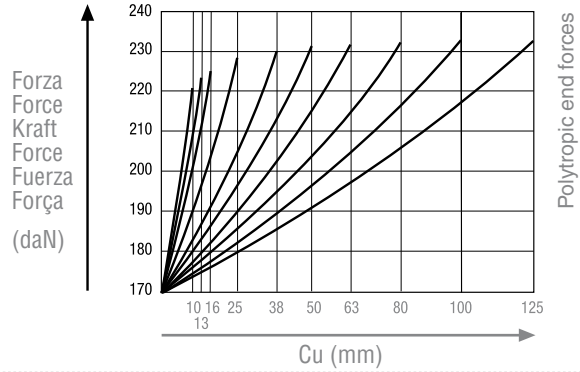
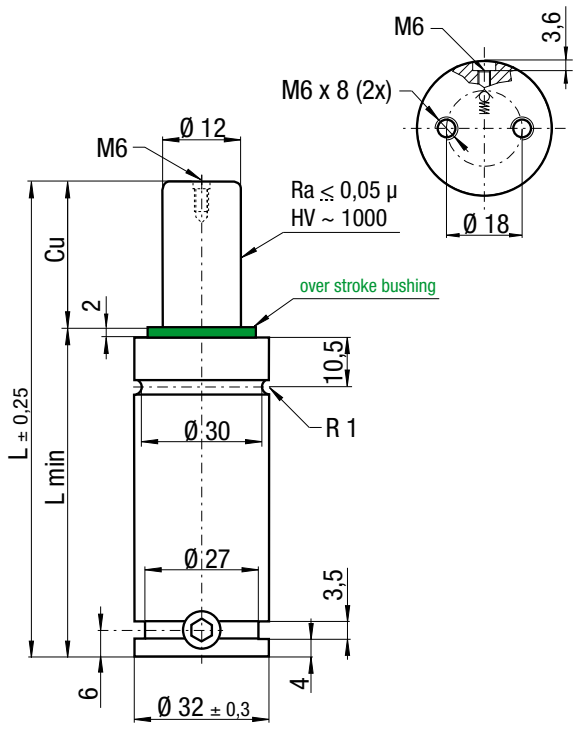

(10) SC 150-050-D
ORDER (10) SC 150-050-D-N

Fixings

Max. Speed 1,8 m/s	°F 32 °C 0 176 80		P max 150 bar 2175 psi	P min 20 bar 290 psi	S 1,13 cm ²		Maintenance kit 39BMSC00150D	
------------------------------	--	--	-------------------------------------	-----------------------------------	-------------------------------------	--	--	--

Technical specifications

Code	Cu mm	L mm	Lmin mm	Fo at 150 bar/+20 °C daN (±5%)	Vo cm ³	connecting hole M6 Micro hose	Kg
SC 150 - 010 - D	10	70	60	170	6,6	SC 150 - 010 - D - N	~0,28
SC 150 - 013 - D	12,7	75,4	62,7	170	8,2	SC 150 - 013 - D - N	~0,29
SC 150 - 016 - D	16	82	66	170	9,9	SC 150 - 016 - D - N	~0,30
SC 150 - 025 - D	25	100	75	170	15	SC 150 - 025 - D - N	~0,33
SC 150 - 038 - D	38	126	88	170	22,2	SC 150 - 038 - D - N	~0,36
SC 150 - 050 - D	50	150	100	170	28,9	SC 150 - 050 - D - N	~0,40
SC 150 - 063 - D	63,5	177	113,5	170	36,2	SC 150 - 063 - D - N	~0,44
SC 150 - 080 - D	80	210	130	170	45,7	SC 150 - 080 - D - N	~0,49
SC 150 - 100 - D	100	250	150	170	56,9	SC 150 - 100 - D - N	~0,55
SC 150 - 125 - D	125	300	175	170	70,9	SC 150 - 125 - D - N	~0,64

Info pg. 229



PHASING OUT → SC 250 D

SC 250

ISO 11901 Standard - ISO 11901 Standard - ISO 11901 Standard -
 Conforme ISO 11901 - ISO 11901 Standard - Norma ISO 11901

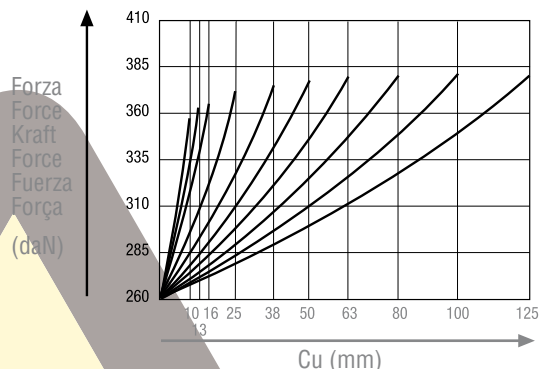
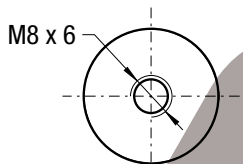
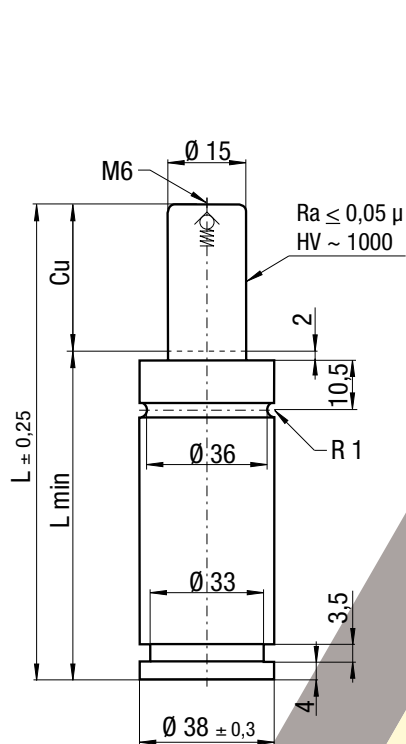

Polytropic end forces

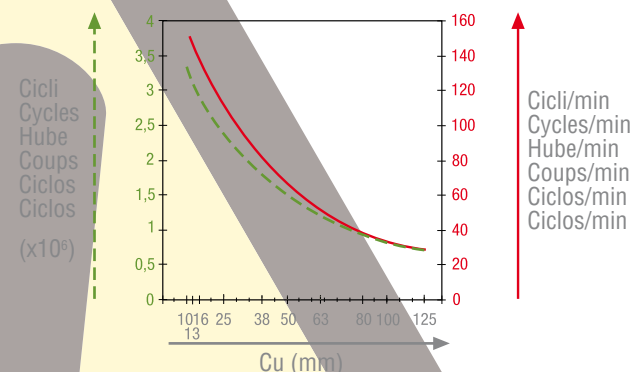

Cicli/min
 Cycles/min
 Hube/min
 Coups/min
 Ciclos/min
 Ciclos/min

SC
 SCF



(10) SC 250-050-B

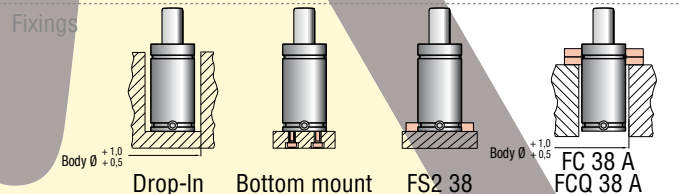

Max. Speed
 1,8 m/s

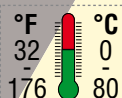

P max
 150 bar
 2175 psi

P min
 20 bar
 290 psi

S
 1,77
 cm²

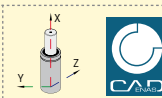

Maintenance kit
 39BMSC00250B

Technical specifications

Code	Cu mm	L mm	Lmin mm	Fo at 150 bar/+20 °C daN (±5%)	Vo cm ³		
SC 250 - 010 - B	10	70	60	260	-	-	~0,40
SC 250 - 013 - B	13	75,4	62,7	260	-	-	~0,41
SC 250 - 016 - B	16	82	66	260	-	-	~0,43
SC 250 - 025 - B	25	100	75	260	-	-	~0,48
SC 250 - 038 - B	38	126	88	260	-	-	~0,54
SC 250 - 050 - B	50	150	100	260	-	-	~0,60
SC 250 - 063 - B	63	177	113,5	260	-	-	~0,66
SC 250 - 080 - B	80	210	130	260	-	-	~0,74
SC 250 - 100 - B	100	250	150	260	-	-	~0,81
SC 250 - 125 - B	125	300	175	260	-	-	~0,98

SC 250

ISO 11901
VDI 3003
CNOMO E24.54815.N



ISO 11901 Standard - ISO 11901 Standard - ISO 11901 Standard -
Conforme ISO 11901 - ISO 11901 Standard - Norma ISO 11901

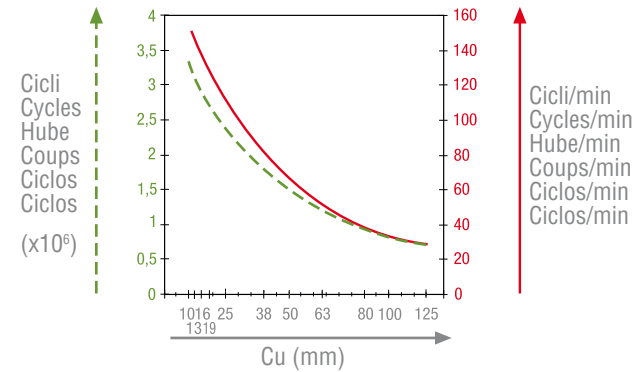
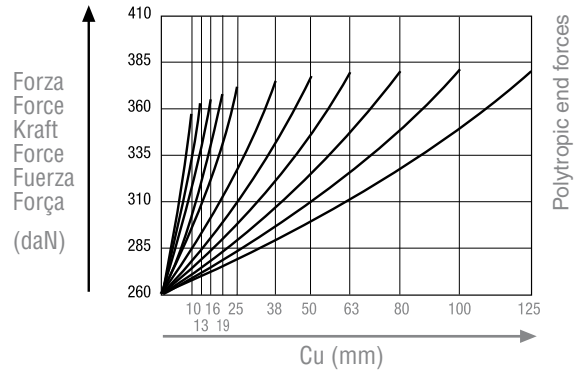
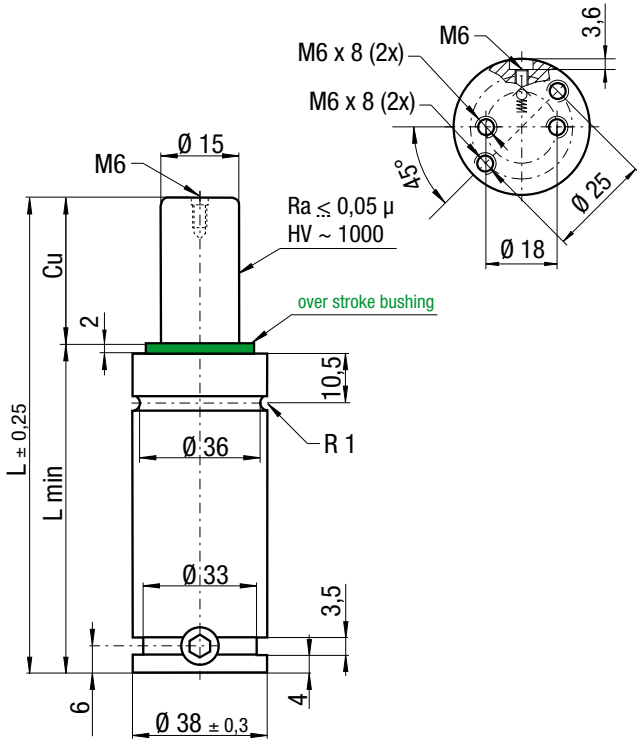

(10) SC 250-050-D
ORDER (10) SC 250-050-D-N

Fixings

Max. Speed 1,8 m/s	°F 32 176	°C 0 80		P max 150 bar 2175 psi	P min 20 bar 290 psi	S 1,77 cm ²		Maintenance kit 39BMSC00250D	
------------------------------	------------------------	----------------------	--	-------------------------------------	-----------------------------------	-------------------------------------	--	--	--

Technical specifications

Code	Cu mm	L mm	Lmin mm	Fo at 150 bar/+20 °C daN (±5%)	Vo cm ³	connecting hole M6 Micro hose	 Kg
SC 250 - 010 - D	10	70	60	260	8,7	SC 250 - 010 - D - N	~0,40
SC 250 - 013 - D	12,7	75,4	62,7	260	10,9	SC 250 - 013 - D - N	~0,41
SC 250 - 016 - D	16	82	66	260	13,1	SC 250 - 016 - D - N	~0,43
SC 250 - 019 - D	19	88	69	260	16,2	SC 250 - 019 - D - N	~0,45
SC 250 - 025 - D	25	100	75	260	19,7	SC 250 - 025 - D - N	~0,48
SC 250 - 038 - D	38	126	88	260	29,3	SC 250 - 038 - D - N	~0,54
SC 250 - 050 - D	50	150	100	260	38,1	SC 250 - 050 - D - N	~0,60
SC 250 - 063 - D	63,5	177	113,5	260	47,6	SC 250 - 063 - D - N	~0,66
SC 250 - 080 - D	80	210	130	260	60,1	SC 250 - 080 - D - N	~0,74
SC 250 - 100 - D	100	250	150	260	74,6	SC 250 - 100 - D - N	~0,81
SC 250 - 125 - D	125	300	175	260	93,2	SC 250 - 125 - D - N	~0,98

Info pg. 229

ISO 11901 Standard - ISO 11901 Standard - ISO 11901 Standard -
Conforme ISO 11901 - ISO 11901 Standard - Norma ISO 11901

PED ISO 11901
VDI 3003
97/23/EC CNOMO E24.54815.N

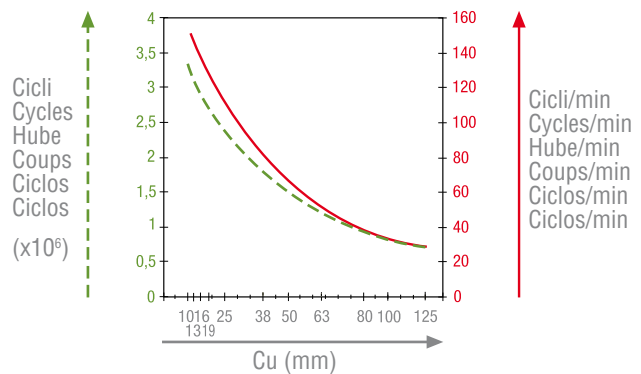
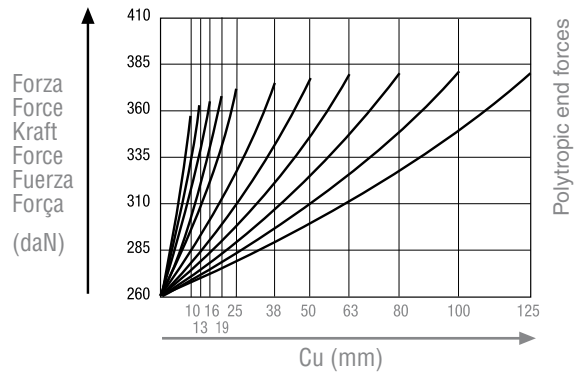
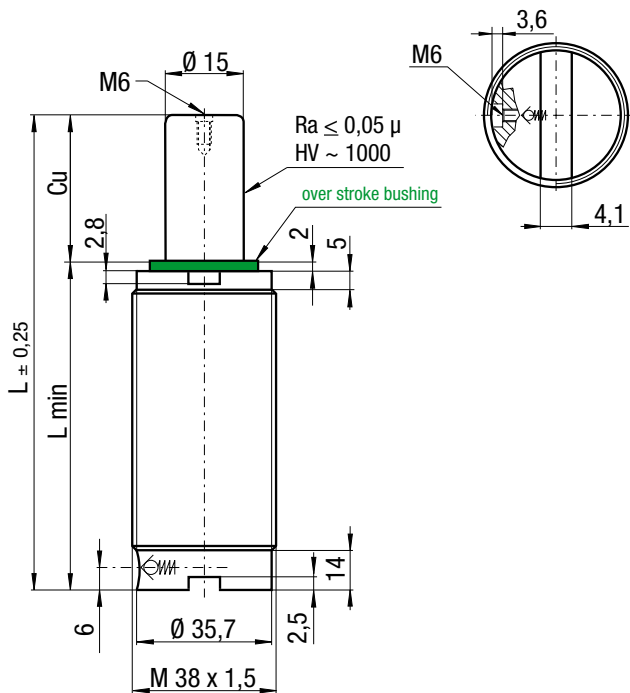

SC
SCF

(10) SCF 250-050-D
ORDER (10) SCF 250-050-D-N



Fixings

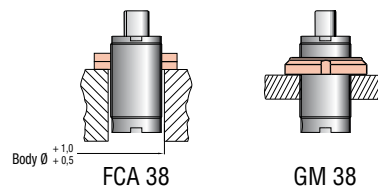

Max. Speed
1,8 m/s

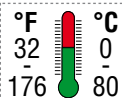

P max
150 bar
2175 psi

P min
20 bar
290 psi

S
1,77
cm²



Maintenance kit
39BMSC00250D



Technical specifications

Code		Cu	L	Lmin	Fo	Vo	connecting hole M6	kg
PHASING OUT	NEW	mm	mm	mm	at 150 bar/+20 °C daN (±5%)	cm ³	Micro hose	
SCF 250 - 010 - A	SCF 250 - 010 - D	10	70	60	260	8,7	SCF 250 - 010 - D - N	~0,37
SCF 250 - 013 - A	SCF 250 - 013 - D	12,7	75,4	62,7	260	10,9	SCF 250 - 013 - D - N	~0,38
SCF 250 - 016 - A	SCF 250 - 016 - D	16	82	66	260	13,1	SCF 250 - 016 - D - N	~0,39
-	SCF 250 - 019 - D	19	88	69	260	16,2	SCF 250 - 019 - D - N	~0,42
SCF 250 - 025 - A	SCF 250 - 025 - D	25	100	75	260	19,7	SCF 250 - 025 - D - N	~0,44
SCF 250 - 038 - A	SCF 250 - 038 - D	38	126	88	260	29,3	SCF 250 - 038 - D - N	~0,50
SCF 250 - 050 - A	SCF 250 - 050 - D	50	150	100	260	38,1	SCF 250 - 050 - D - N	~0,55
SCF 250 - 063 - A	SCF 250 - 063 - D	63,5	177	113,5	260	47,6	SCF 250 - 063 - D - N	~0,63
SCF 250 - 080 - A	SCF 250 - 080 - D	80	210	130	260	60,1	SCF 250 - 080 - D - N	~0,70
SCF 250 - 100 - A	SCF 250 - 100 - D	100	250	150	260	74,6	SCF 250 - 100 - D - N	~0,75
SCF 250 - 125 - A	SCF 250 - 125 - D	125	300	175	260	93,2	SCF 250 - 125 - D - N	~0,93

Info pg. 229

SC 500

ISO 11901
VDI 3003
CNOMO E24.54815.N



ISO 11901 Standard - ISO 11901 Standard - ISO 11901 Standard -
Conforme ISO 11901 - ISO 11901 Standard - Norma ISO 11901

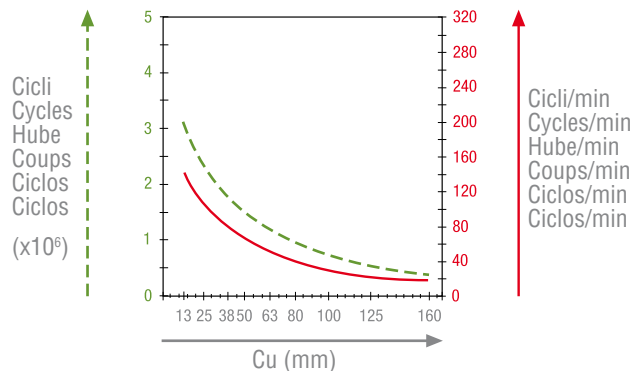
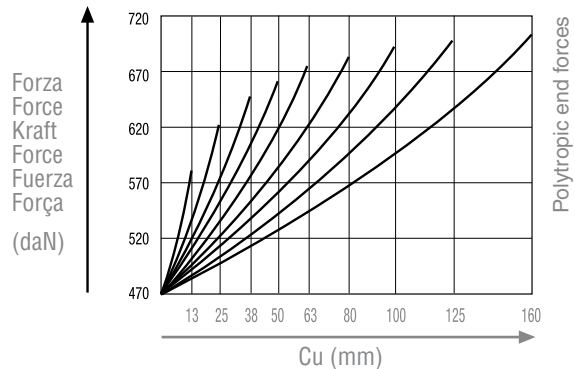
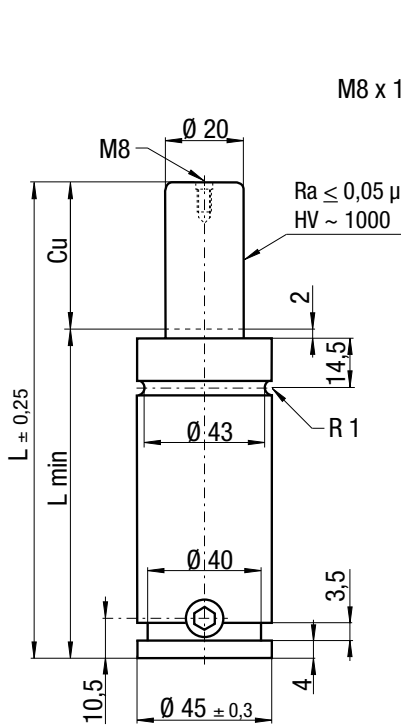

(10) SC 500-050-B
ORDER (10) SC 500-050-B-N

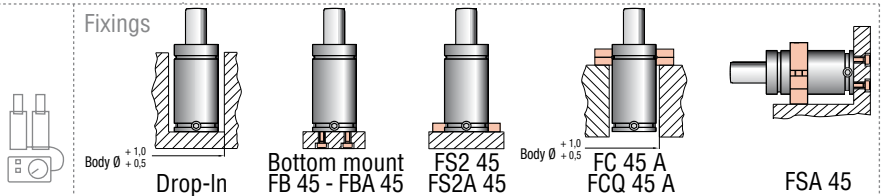

Max. Speed 1,8 m/s	°F 32 °C 0 176 80		P max 150 bar 2175 psi	P min 20 bar 290 psi	S 3,14 cm ²		Maintenance kit 39BMSC00500B
------------------------------	--	--	-------------------------------------	-----------------------------------	-------------------------------------	--	--

Technical specifications

Code	Cu mm	L mm	Lmin mm	Fo at 150 bar/+20 °C daN (±5%)	Vo cm ³	connecting hole G1/8" Jic 37° hose Minimess hose	 Kg
SC 500 - 013 - B	12,7	110,4	97,7	470	28	SC 500 - 013 - B - N	~0,90
SC 500 - 025 - B	25	135	110	470	42	SC 500 - 025 - B - N	~1,00
SC 500 - 038 - B	38	161	123	470	57	SC 500 - 038 - B - N	~1,10
SC 500 - 050 - B	50	185	135	470	71	SC 500 - 050 - B - N	~1,20
SC 500 - 063 - B	63,5	212	148,5	470	86	SC 500 - 063 - B - N	~1,30
SC 500 - 080 - B	80	245	165	470	105	SC 500 - 080 - B - N	~1,40
SC 500 - 100 - B	100	285	185	470	129	SC 500 - 100 - B - N	~1,60
SC 500 - 125 - B	125	335	210	470	157	SC 500 - 125 - B - N	~1,80
SC 500 - 160 - B	160	405	245	470	198	SC 500 - 160 - B - N	~2,10

Info pg. 229

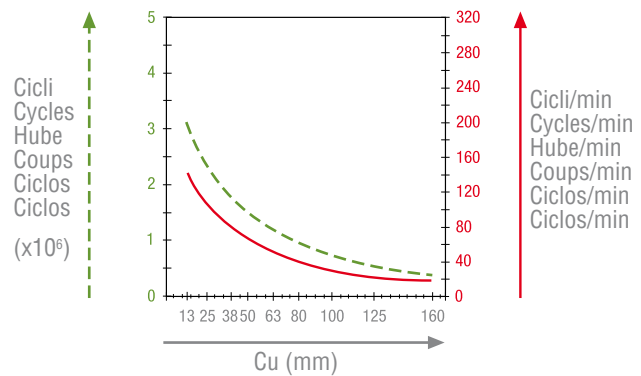
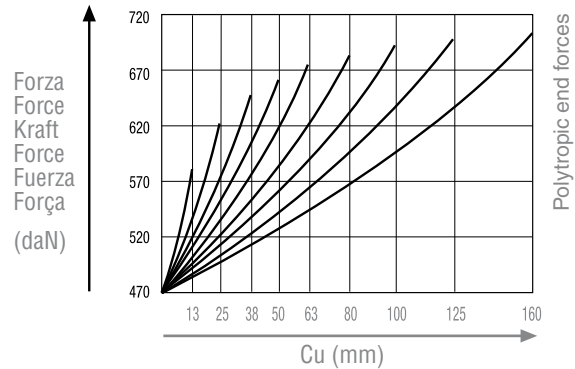
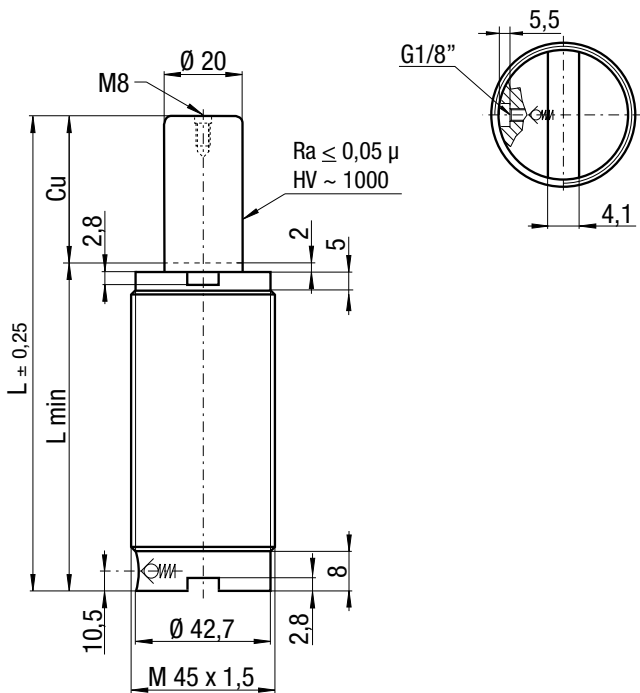

SC
SCF

(10) SCF 500-050-A
ORDER (10) SCF 500-050-A-N



Fixings

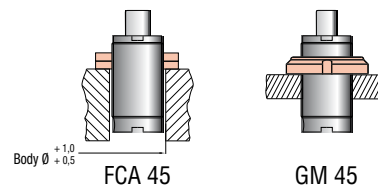

Max. Speed
1,8 m/s

°F 32
°C 0
176 80



P max
150 bar
2175 psi

P min
20 bar
290 psi

S
3,14
cm²



Maintenance kit
39BMSC00500B

Technical specifications

Code	Cu mm	L mm	Lmin mm	F ₀ at 150 bar/+20 °C daN (±5%)	V ₀ cm ³	connecting hole G1/8" Jic 37° hose Minimesse hose	Kg
SCF 500 - 013 - A	12,7	110,4	97,7	470	28	SCF 500 - 013 - A - N	~0,90
SCF 500 - 025 - A	25	135	110	470	42	SCF 500 - 025 - A - N	~0,93
SCF 500 - 038 - A	38	161	123	470	57	SCF 500 - 038 - A - N	~1,09
SCF 500 - 050 - A	50	185	135	470	71	SCF 500 - 050 - A - N	~1,17
SCF 500 - 063 - A	63,5	212	148,5	470	86	SCF 500 - 063 - A - N	~1,27
SCF 500 - 080 - A	80	245	165	470	105	SCF 500 - 080 - A - N	~1,39
SCF 500 - 100 - A	100	285	185	470	129	SCF 500 - 100 - A - N	~1,56
SCF 500 - 125 - A	125	335	210	470	157	SCF 500 - 125 - A - N	~1,70
SCF 500 - 160 - A	160	405	245	470	198	SCF 500 - 160 - A - N	~1,87

Info pg. 229

SC 750

ISO 11901
VDI 3003
CNOMO E24.54815.N



ISO 11901 Standard - ISO 11901 Standard - ISO 11901 Standard -
Conforme ISO 11901 - ISO 11901 Standard - Norma ISO 11901

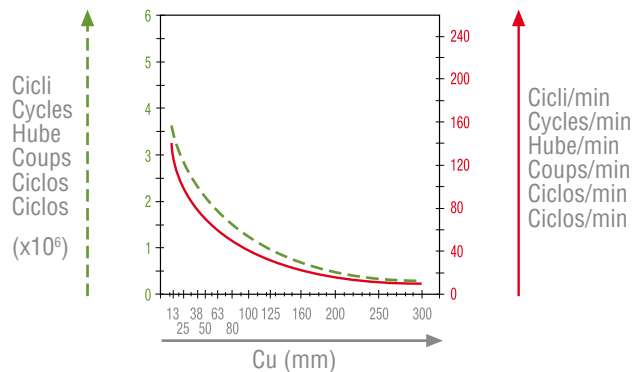
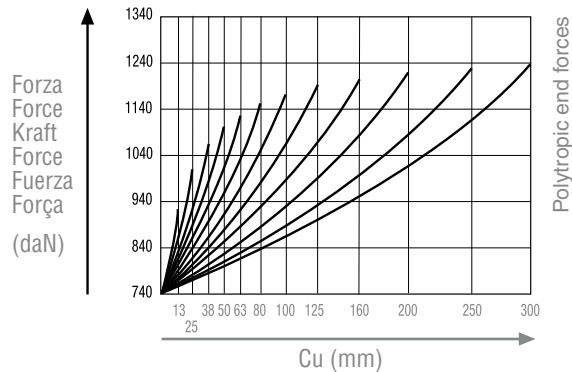
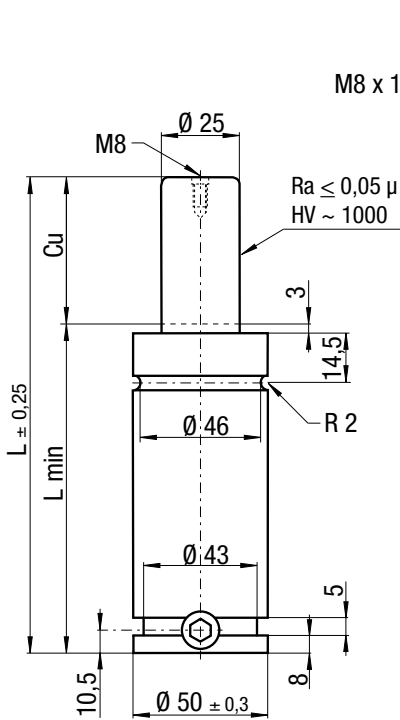

ORDER (10) SC 750-050-B-N

Fixings: Drop-In, Bottom mount (FB 50 - FBA 50), FS2 50 (FS2A 50), FC 50 A (FCQ 50 A), FSA 50

Max. Speed 1,8 m/s	°F 32 176	°C 0 80	N₂	P max 150 bar 2175 psi	P min 20 bar 290 psi	S 4,91 cm ²	Maintenance kit 39BMSC00750B
------------------------------	------------------------	----------------------	----------------------	-------------------------------------	-----------------------------------	-------------------------------------	--

Technical specifications

Code	Cu mm	L mm	Lmin mm	Fo at 150 bar/+20 °C daN (±5%)	Vo cm ³	connecting hole G1/8" Jic 37° hose Minimesh hose	Kg
SC 750 - 013 - B	12,7	120,4	107,7	740	46	SC 750 - 013 - B - N	~1,25
SC 750 - 025 - B	25	145	120	740	64	SC 750 - 025 - B - N	~1,38
SC 750 - 038 - B	38	171	133	740	83	SC 750 - 038 - B - N	~1,53
SC 750 - 050 - B	50	195	145	740	101	SC 750 - 050 - B - N	~1,65
SC 750 - 063 - B	63,5	222	158,5	740	121	SC 750 - 063 - B - N	~1,80
SC 750 - 080 - B	80	255	175	740	145	SC 750 - 080 - B - N	~1,96
SC 750 - 100 - B	100	295	195	740	175	SC 750 - 100 - B - N	~2,09
SC 750 - 125 - B	125	345	220	740	212	SC 750 - 125 - B - N	~2,33
SC 750 - 160 - B	160	415	255	740	264	SC 750 - 160 - B - N	~2,68
SC 750 - 200 - B	200	495	295	740	323	SC 750 - 200 - B - N	~3,10
SC 750 - 250 - B	250	595	345	740	398	SC 750 - 250 - B - N	~3,60
SC 750 - 300 - B	300	695	395	740	472	SC 750 - 300 - B - N	~4,10

Info pg. 229

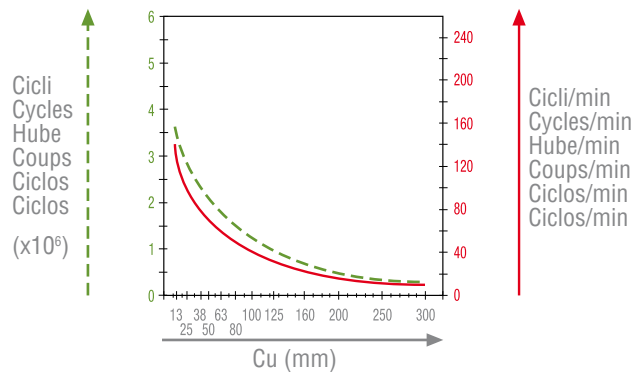
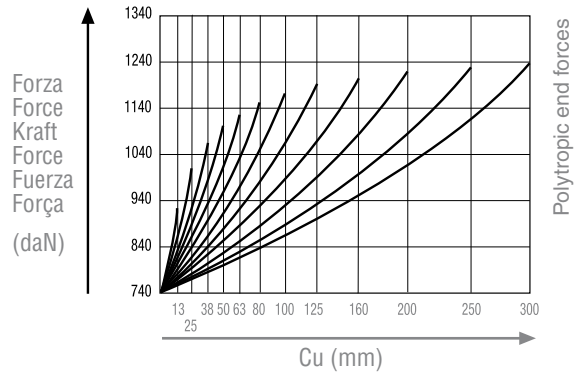
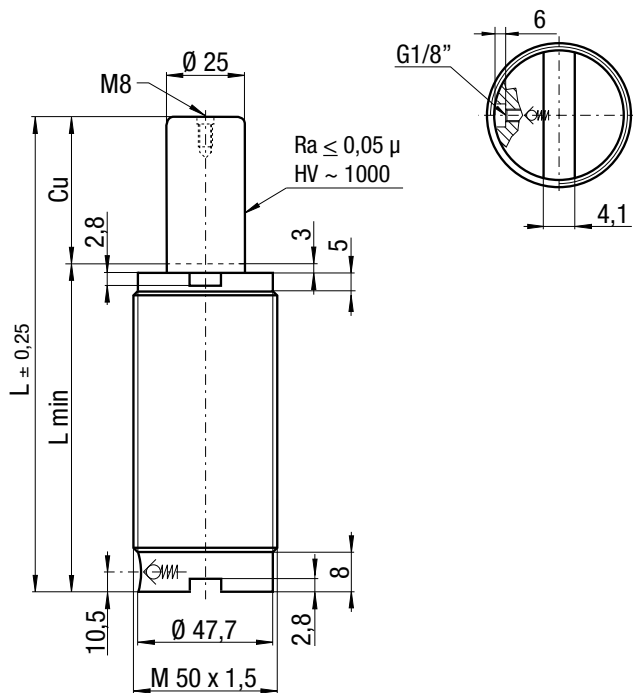

SC
SCF

(10) SCF 750-050-A
ORDER (10) SCF 750-050-A-N



Fixings

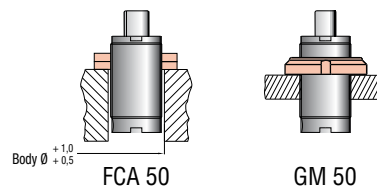

Max. Speed 1,8 m/s	°F 32 176	°C 0 80	N ₂	P max 150 bar 2175 psi	P min 20 bar 290 psi	S 4,91 cm ²		Maintenance kit 39BMSC00750B
------------------------------	------------------------	----------------------	----------------	-------------------------------------	-----------------------------------	-------------------------------------	--	--

Technical specifications

Code	Cu mm	L mm	Lmin mm	F ₀ at 150 bar/+20 °C daN (±5%)	V ₀ cm ³	connecting hole G1/8" Jic 37° hose Minimess hose	Kg
SCF 750 - 013 - A	12,7	120,4	107,7	740	46	SCF 750 - 013 - A - N	~1,20
SCF 750 - 025 - A	25	145	120	740	64	SCF 750 - 025 - A - N	~1,30
SCF 750 - 038 - A	38	171	133	740	83	SCF 750 - 038 - A - N	~1,39
SCF 750 - 050 - A	50	195	145	740	101	SCF 750 - 050 - A - N	~1,51
SCF 750 - 063 - A	63,5	222	158,5	740	121	SCF 750 - 063 - A - N	~1,60
SCF 750 - 080 - A	80	255	175	740	145	SCF 750 - 080 - A - N	~1,75
SCF 750 - 100 - A	100	295	195	740	175	SCF 750 - 100 - A - N	~1,97
SCF 750 - 125 - A	125	345	220	740	212	SCF 750 - 125 - A - N	~2,32
SCF 750 - 160 - A	160	415	255	740	264	SCF 750 - 160 - A - N	~2,56
SCF 750 - 200 - A	200	495	295	740	323	SCF 750 - 200 - A - N	~2,90
SCF 750 - 250 - A	250	595	345	740	398	SCF 750 - 250 - A - N	~3,49
SCF 750 - 300 - A	300	695	395	740	472	SCF 750 - 300 - A - N	~3,96

Info pg. 229

SC 1500

ISO 11901
VDI 3003
CNOMO E24.54815.N



ISO 11901 Standard - ISO 11901 Standard - ISO 11901 Standard -
Conforme ISO 11901 - ISO 11901 Standard - Norma ISO 11901

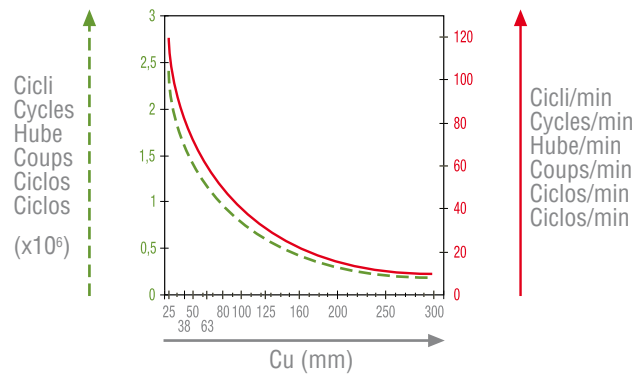
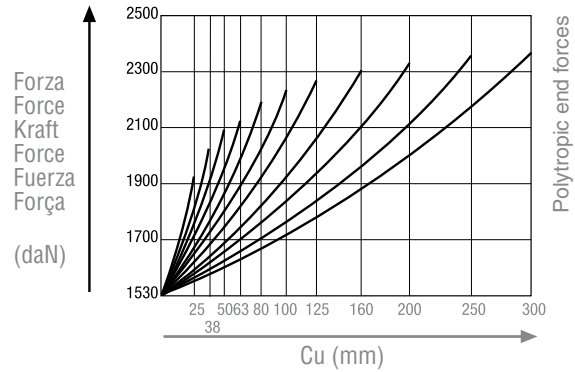
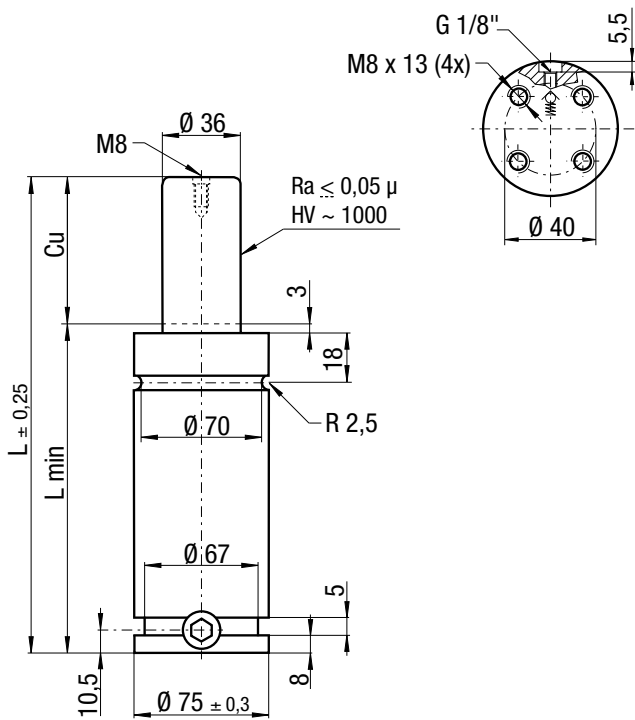

(10) SC 1500-050-B
ORDER (10) SC 1500-050-B-N



Fixings

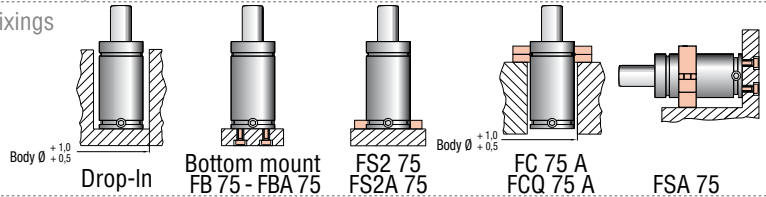

Max. Speed 1,8 m/s	°F 32 176	°C 0 80	N ₂	P max 150 bar 2175 psi	P min 20 bar 290 psi	S 10,18 cm ²		Maintenance kit 39BMSC01500B
------------------------------	------------------------	----------------------	----------------	-------------------------------------	-----------------------------------	--------------------------------------	--	--

Technical specifications

Code	Cu mm	L mm	Lmin mm	Fo at 150 bar/+20 °C daN (±5%)	Vo cm ³	connecting hole G1/8" Jic 37° hose Minimesh hose	Kg
SC 1500 - 025 - B	25	160	135	1530	151	SC 1500 - 025 - B - N	~3,64
SC 1500 - 038 - B	38	186	148	1530	194	SC 1500 - 038 - B - N	~3,91
SC 1500 - 050 - B	50	210	160	1530	233	SC 1500 - 050 - B - N	~4,15
SC 1500 - 063 - B	63,5	237	173,5	1530	278	SC 1500 - 063 - B - N	~4,47
SC 1500 - 080 - B	80	270	190	1530	333	SC 1500 - 080 - B - N	~4,81
SC 1500 - 100 - B	100	310	210	1530	400	SC 1500 - 100 - B - N	~5,22
SC 1500 - 125 - B	125	360	235	1530	483	SC 1500 - 125 - B - N	~5,75
SC 1500 - 160 - B	160	430	270	1530	599	SC 1500 - 160 - B - N	~6,33
SC 1500 - 200 - B	200	510	310	1530	731	SC 1500 - 200 - B - N	~7,34
SC 1500 - 250 - B	250	610	360	1530	897	SC 1500 - 250 - B - N	~8,50
SC 1500 - 300 - B	300	710	410	1530	1063	SC 1500 - 300 - B - N	~9,60

Info pg. 229

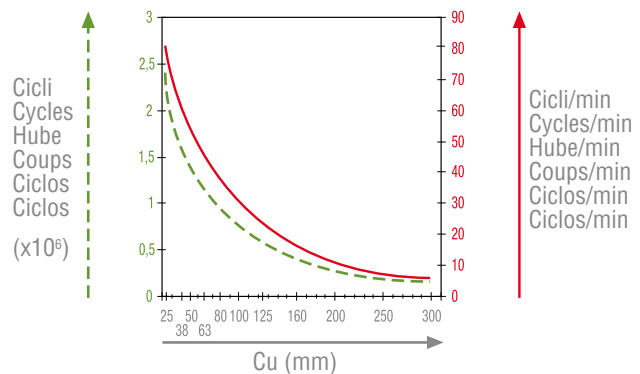
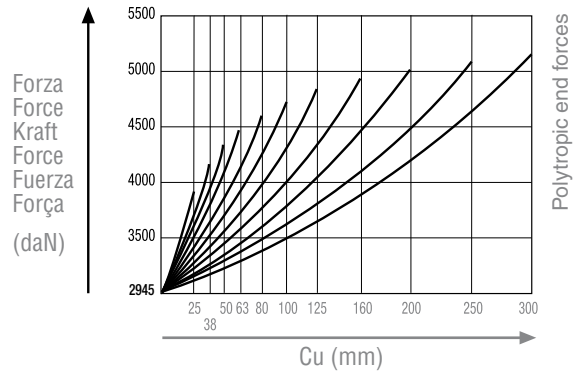
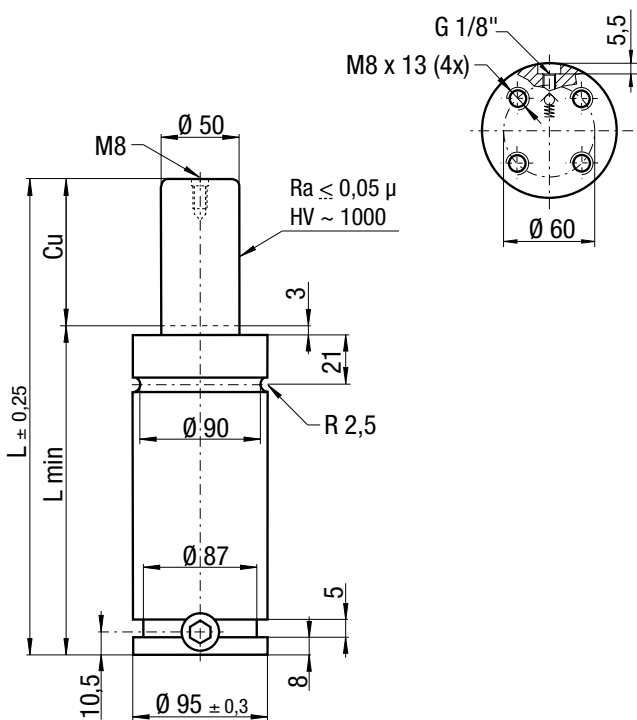

SC
SCF

(10) SC 3000-050-B
ORDER (10) SC 3000-050-B-N



Fixings

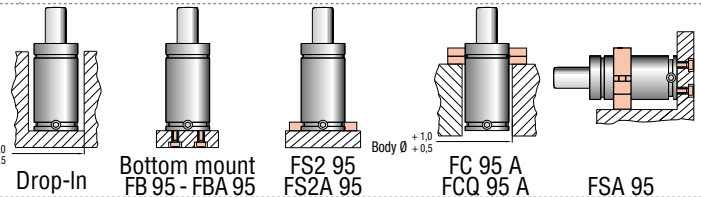

Max. Speed 1,8 m/s	°F 32 °C 0 176 80	N ₂	P max 150 bar 2175 psi	P min 20 bar 290 psi	S 19,63 cm ²		Maintenance kit 39BMSC03000B
------------------------------	--	----------------	-------------------------------------	-----------------------------------	--------------------------------------	--	--

Technical specifications

Code	Cu mm	L mm	Lmin mm	Fo at 150 bar/+20 °C daN (±5%)	Vo cm ³	connecting hole G1/8" Jic 37° hose Minimess hose	Kg
SC 3000 - 025 - B	25	170	145	2945	274	SC 3000 - 025 - B - N	~6,36
SC 3000 - 038 - B	38	196	158	2945	346	SC 3000 - 038 - B - N	~6,75
SC 3000 - 050 - B	50	220	170	2945	413	SC 3000 - 050 - B - N	~7,35
SC 3000 - 063 - B	63,5	247	183,5	2945	488	SC 3000 - 063 - B - N	~7,87
SC 3000 - 080 - B	80	280	200	2945	579	SC 3000 - 080 - B - N	~8,44
SC 3000 - 100 - B	100	320	220	2945	691	SC 3000 - 100 - B - N	~9,03
SC 3000 - 125 - B	125	370	245	2945	829	SC 3000 - 125 - B - N	~10,1
SC 3000 - 160 - B	160	440	280	2945	1024	SC 3000 - 160 - B - N	~11,3
SC 3000 - 200 - B	200	520	320	2945	1246	SC 3000 - 200 - B - N	~12,8
SC 3000 - 250 - B	250	620	370	2945	1524	SC 3000 - 250 - B - N	~14,5
SC 3000 - 300 - B	300	720	420	2945	1801	SC 3000 - 300 - B - N	~16,2

Info pg. 229

SC 5000

ISO 11901
VDI 3003
CNOMO E24.54815.N



ISO 11901 Standard - ISO 11901 Standard - ISO 11901 Standard -
Conforme ISO 11901 - ISO 11901 Standard - Norma ISO 11901

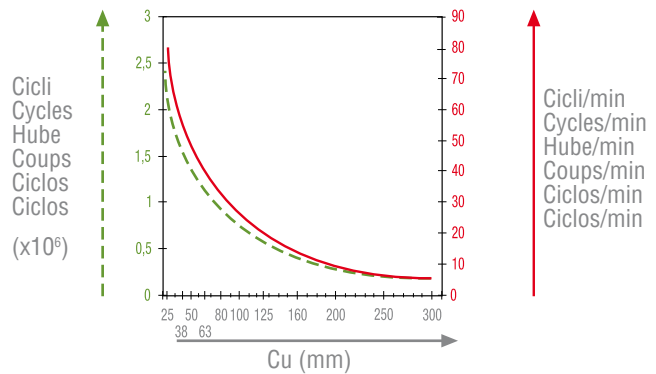
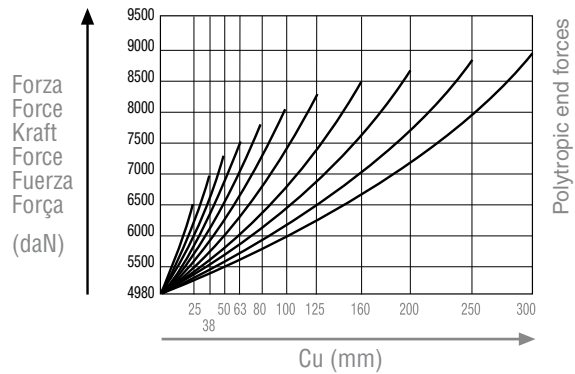
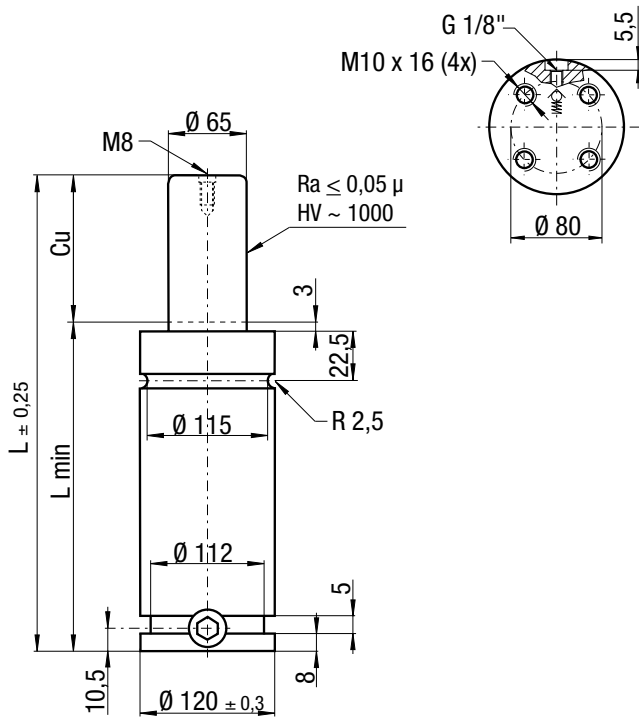

ORDER (10) SC 5000-050-B
ORDER (10) SC 5000-050-B-N

Fixings: Drop-In, Bottom mount (FB 120 - FBA 120), FS2 120 (FS2A 120), FC 120 A (FCQ 120 A), FSA 120

Max. Speed 1,8 m/s	°F 32 176	°C 0 80	N ₂	P max 150 bar 2175 psi	P min 20 bar 290 psi	S 33,18 cm ²		Maintenance kit 39BMSC05000B
------------------------------	------------------------	----------------------	----------------	-------------------------------------	-----------------------------------	--------------------------------------	--	--

Technical specifications

Code	Cu mm	L mm	Lmin mm	F ₀ at 150 bar/+20 °C daN (±5%)	V ₀ cm ³	connecting hole G1/8" Jic 37° hose Minimess hose	Kg
SC 5000 - 025 - B	25	190	165	4980	446	SC 5000 - 025 - B - N	~12,2
SC 5000 - 038 - B	38	216	178	4980	559	SC 5000 - 038 - B - N	~12,9
SC 5000 - 050 - B	50	240	190	4980	663	SC 5000 - 050 - B - N	~13,7
SC 5000 - 063 - B	63,5	267	203,5	4980	780	SC 5000 - 063 - B - N	~14,5
SC 5000 - 080 - B	80	300	220	4980	924	SC 5000 - 080 - B - N	~15,4
SC 5000 - 100 - B	100	340	240	4980	1097	SC 5000 - 100 - B - N	~16,7
SC 5000 - 125 - B	125	390	265	4980	1314	SC 5000 - 125 - B - N	~18,3
SC 5000 - 160 - B	160	460	300	4980	1618	SC 5000 - 160 - B - N	~20,1
SC 5000 - 200 - B	200	540	340	4980	1965	SC 5000 - 200 - B - N	~22,3
SC 5000 - 250 - B	250	640	390	4980	2399	SC 5000 - 250 - B - N	~24,8
SC 5000 - 300 - B	300	740	440	4980	2833	SC 5000 - 300 - B - N	~27,3

Info pg. 229

ISO 11901 Standard - ISO 11901 Standard - ISO 11901 Standard -
 Conforme ISO 11901 - ISO 11901 Standard - Norma ISO 11901

PED ISO 11901
 VDI 3003
 97/23/EC CNOMO E24.54815.N

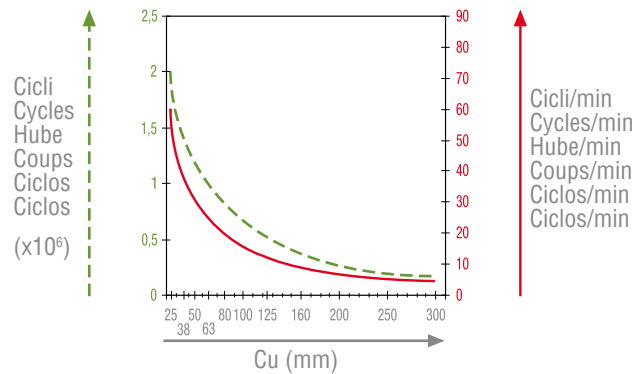
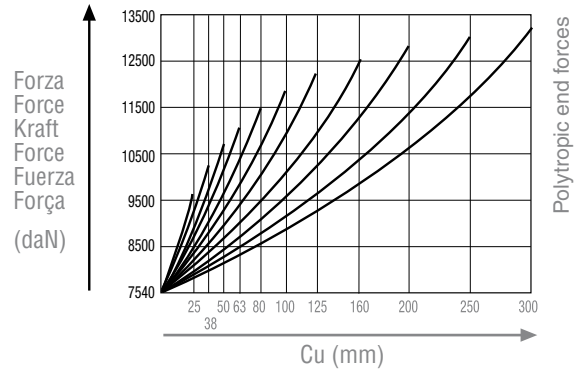
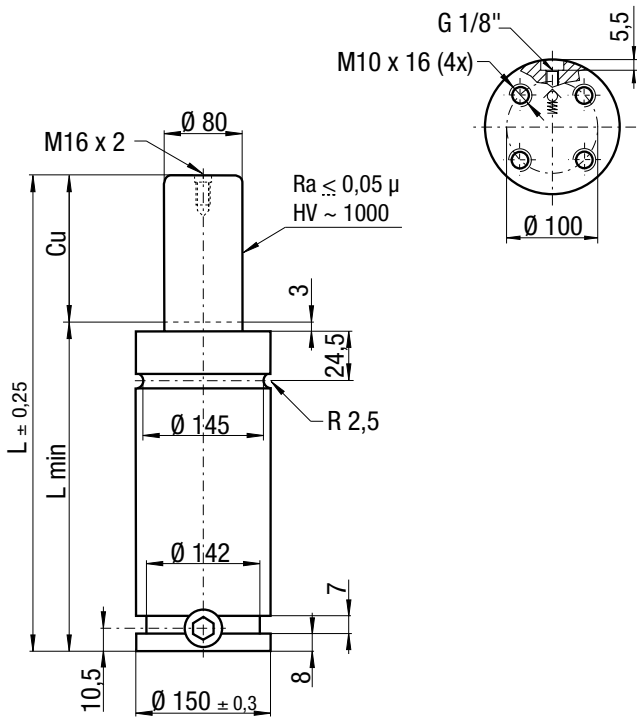

SC
SCF

ORDER (10) SC 7500-050-B
 (10) SC 7500-050-B-N

Fixings

Drop-In, Bottom mount, FS2 150, FC 150 A, FSA 150

Max. Speed 1,8 m/s	°F 32 176	°C 0 80	N₂	P max 150 bar 2175 psi	P min 20 bar 290 psi	S 50,27 cm ²	Maintenance kit 39BMSC07500B
------------------------------	------------------------	----------------------	----------------------	-------------------------------------	-----------------------------------	--------------------------------------	--

Technical specifications

Code	Cu mm	L mm	Lmin mm	F ₀ at 150 bar/+20 °C daN (±5%)	V ₀ cm ³	connecting hole G1/8" Jic 37° hose Minimess hose	Kg
SC 7500 - 025 - B	25	205	180	7540	760	SC 7500 - 025 - B - N	~19,8
SC 7500 - 038 - B	38	231	193	7540	933	SC 7500 - 038 - B - N	~21,0
SC 7500 - 050 - B	50	255	205	7540	1093	SC 7500 - 050 - B - N	~21,8
SC 7500 - 063 - B	63,5	282	218,5	7540	1275	SC 7500 - 063 - B - N	~22,6
SC 7500 - 080 - B	80	315	235	7540	1493	SC 7500 - 080 - B - N	~24,4
SC 7500 - 100 - B	100	355	255	7540	1759	SC 7500 - 100 - B - N	~26,1
SC 7500 - 125 - B	125	405	280	7540	2091	SC 7500 - 125 - B - N	~28,0
SC 7500 - 160 - B	160	475	315	7540	2557	SC 7500 - 160 - B - N	~31,4
SC 7500 - 200 - B	200	555	355	7540	3090	SC 7500 - 200 - B - N	~35,0
SC 7500 - 250 - B	250	655	405	7540	3755	SC 7500 - 250 - B - N	~38,5
SC 7500 - 300 - B	300	755	455	7540	4421	SC 7500 - 300 - B - N	~42,4

Info pg. 229

SC 10000

ISO 11901
VDI 3003
CNOMO E24.54815.N



ISO 11901 Standard - ISO 11901 Standard - ISO 11901 Standard -
Conforme ISO 11901 - ISO 11901 Standard - Norma ISO 11901

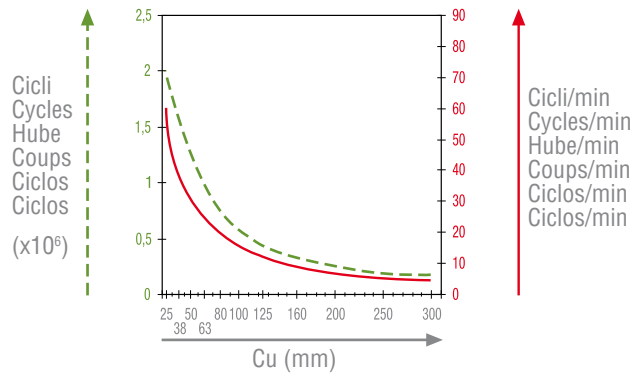
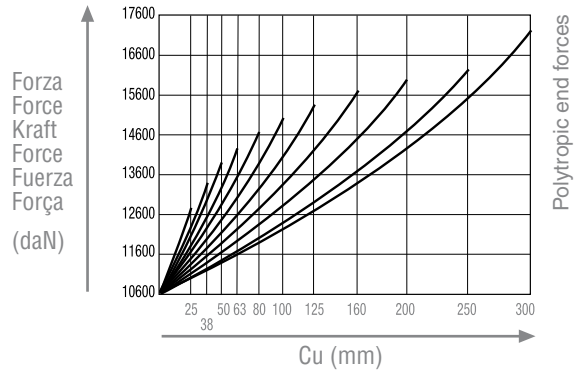
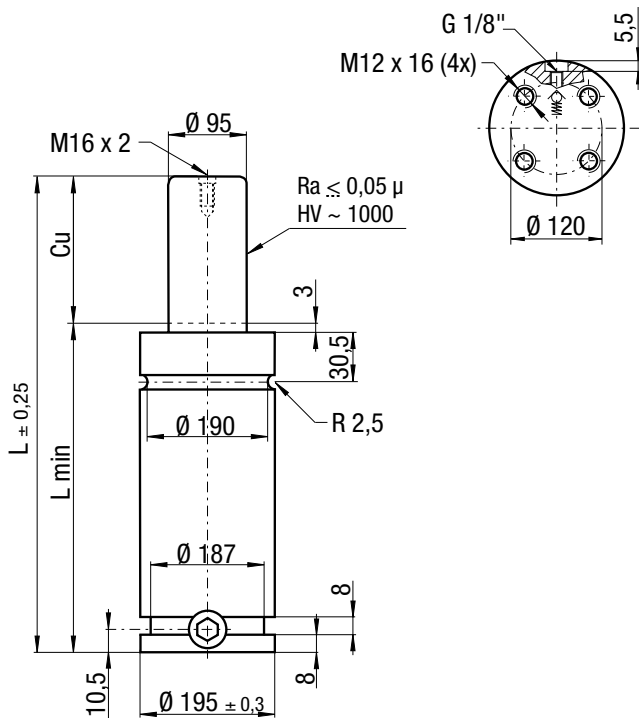

(10) SC 10000-050-C
ORDER (10) SC 10000-050-C-N

Fixings
 Drop-In
 Bottom mount
 FS2 195
 FC 195 A

Max. Speed 1,8 m/s	°F 32 176	°C 0 80	N ₂	P max 150 bar 2175 psi	P min 20 bar 290 psi	S 70,88 cm ²		Maintenance kit 39BMS10000C
------------------------------	------------------------	----------------------	----------------	-------------------------------------	-----------------------------------	--------------------------------------	--	---------------------------------------

Technical specifications

Code	Cu mm	L mm	Lmin mm	Fo at 150 bar/+20 °C daN (±5%)	Vo cm ³	connecting hole G1/8" Jic 37° hose Minimess hose	Kg
SC 10000 - 025 - C	25	210	185	10600	1009	SC 10000 - 025 - C - N	~34,8
SC 10000 - 038 - C	38	236	198	10600	1307	SC 10000 - 038 - C - N	~36,7
SC 10000 - 050 - C	50	260	210	10600	1582	SC 10000 - 050 - C - N	~38,5
SC 10000 - 063 - C	63,5	287	223,5	10600	1881	SC 10000 - 063 - C - N	~40,5
SC 10000 - 080 - C	80	320	240	10600	2270	SC 10000 - 080 - C - N	~43,0
SC 10000 - 100 - C	100	360	260	10600	2729	SC 10000 - 100 - C - N	~46,0
SC 10000 - 125 - C	125	410	285	10600	3302	SC 10000 - 125 - C - N	~49,8
SC 10000 - 160 - C	160	480	320	10600	4105	SC 10000 - 160 - C - N	~55,0
SC 10000 - 200 - C	200	560	360	10600	5022	SC 10000 - 200 - C - N	~61,0
SC 10000 - 250 - C	250	660	410	10600	6169	SC 10000 - 250 - C - N	~68,5
SC 10000 - 300 - C	300	760	460	10600	6657	SC 10000 - 300 - C - N	~76,0

Info pg. 229