

Forza iniziale nulla - Zero force on contact - Ausgangsleistung Null -
Force initiale nulle - Fuerza inicial cero - Força inicial nula

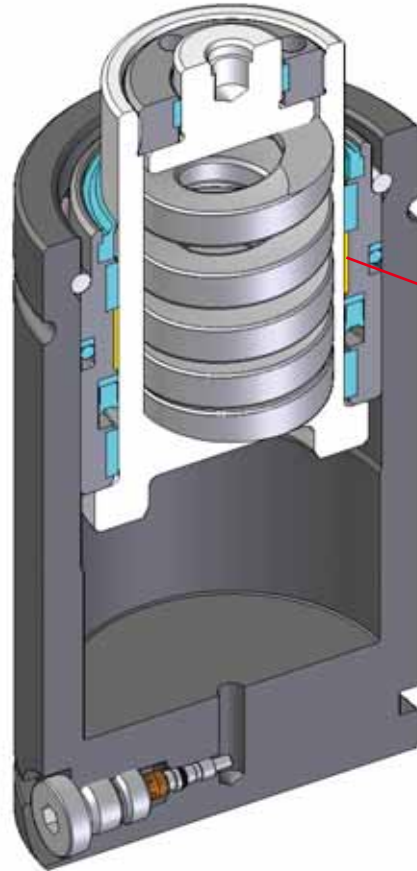

Permanent
Lubrication
on the
Rod

**- 50 %
vibrations**

**- 55 %
noise**

INITIAL IMPACT VIBRATIONS

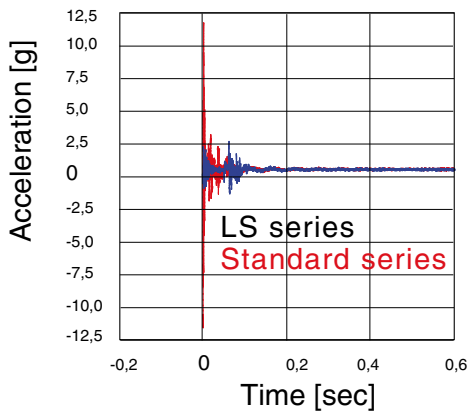

FORCE CURVE

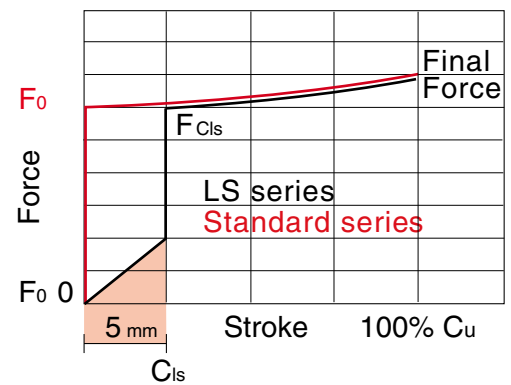

Range chart

| Model | Body Ø mm | Stroke C _u mm | Initial force daN | lifeplus concept | | |
|---------|-----------|--------------------------|-------------------|------------------|------|------|
| | | | | SKUDO | OSAS | OPAS |
| LS 1500 | 75 | 25 - 300 | 1590 | - | - | - |
| LS 2400 | 75 | 25 - 300 | 2385 | - | - | - |
| LS 3000 | 95 | 25 - 300 | 2830 | - | - | - |
| LS 4200 | 95 | 25 - 300 | 4240 | - | - | - |
| LS 5000 | 120 | 25 - 300 | 4418 | - | - | - |
| LS 6600 | 120 | 25 - 300 | 6630 | - | - | - |
| LS 7500 | 150 | 25 - 300 | 7630 | - | - | - |
| LS 9500 | 150 | 25 - 300 | 9540 | - | - | - |

Forza iniziale nulla - Zero force on contact - Ausgangsleistung Null -
Force initiale nulle - Fuerza inicial cero - Força inicial nula

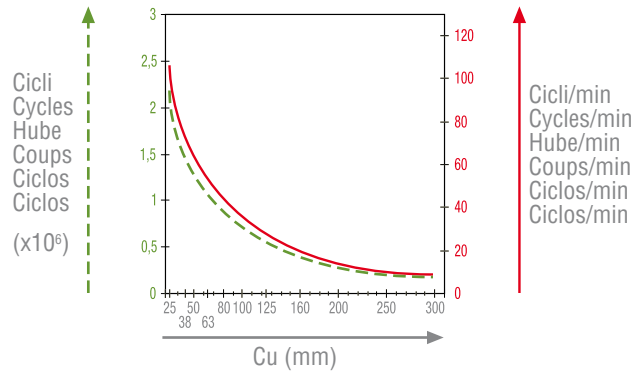
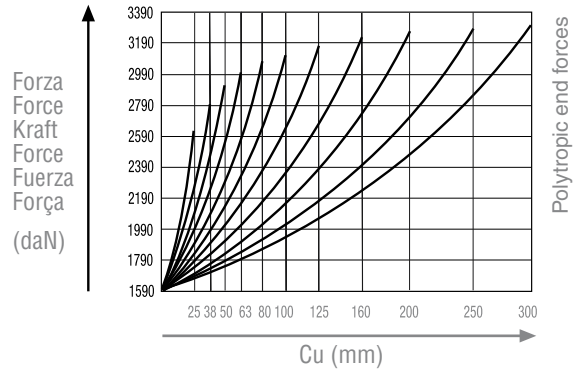
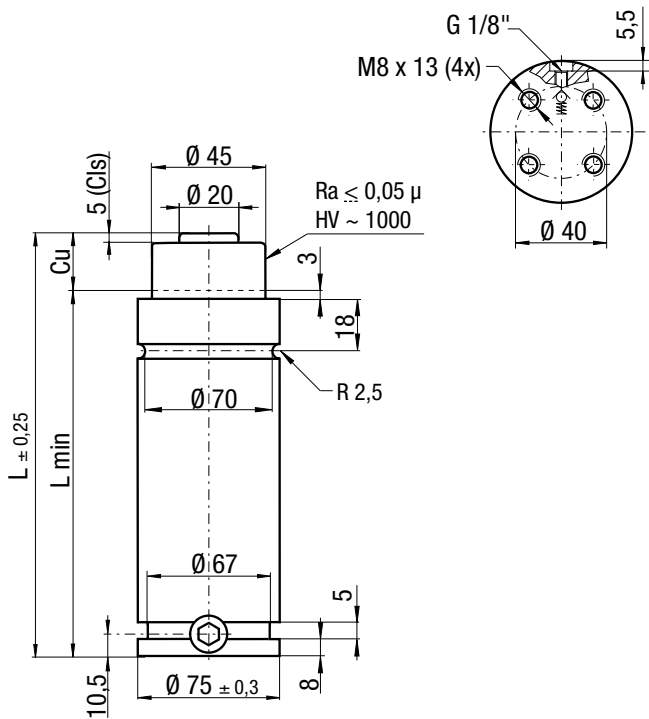

(10) LS 1500-050-A
ORDER (10) LS 1500-050-A-N



Fixings

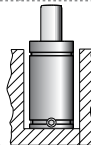

Drop-In



Bottom mount
FB 75 - FBA 75

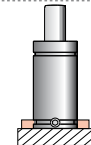

FS2 75
FS2A 75



FC 75 A
FCQ 75 A

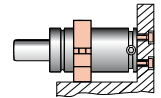

FSA 75

LS

Max. Speed
1,8 m/s

°F 32
°C 0
176 80



P max
100 bar
1450 psi

P min
20 bar
290 psi

S
15,9
cm²



Maintenance kit
39BMLS01500A

Technical specifications

| Code | Cu mm | L mm | Lmin mm | F 0 at 100 bar/+20 °C daN | F Cls at 100 bar/+20 °C daN (±5%) | V0 cm ³ | connecting hole G1/8" Jic 37° hose Minimess hose | Kg |
|-------------------|----------|---------|------------|---------------------------------|---|-----------------------|---|--------|
| LS 1500 - 025 - A | 25 | 160 | 135 | 0 | 1590 | 126 | LS 1500 - 025 - A - N | ~3,71 |
| LS 1500 - 038 - A | 38 | 186 | 148 | 0 | 1590 | 174 | LS 1500 - 038 - A - N | ~3,79 |
| LS 1500 - 050 - A | 50 | 210 | 160 | 0 | 1590 | 218 | LS 1500 - 050 - A - N | ~3,89 |
| LS 1500 - 063 - A | 63,5 | 237 | 173,5 | 0 | 1590 | 268 | LS 1500 - 063 - A - N | ~4,48 |
| LS 1500 - 080 - A | 80 | 270 | 190 | 0 | 1590 | 329 | LS 1500 - 080 - A - N | ~4,73 |
| LS 1500 - 100 - A | 100 | 310 | 210 | 0 | 1590 | 403 | LS 1500 - 100 - A - N | ~4,89 |
| LS 1500 - 125 - A | 125 | 360 | 235 | 0 | 1590 | 495 | LS 1500 - 125 - A - N | ~5,57 |
| LS 1500 - 160 - A | 160 | 430 | 270 | 0 | 1590 | 624 | LS 1500 - 160 - A - N | ~6,33 |
| LS 1500 - 200 - A | 200 | 510 | 310 | 0 | 1590 | 771 | LS 1500 - 200 - A - N | ~7,19 |
| LS 1500 - 250 - A | 250 | 610 | 360 | 0 | 1590 | 955 | LS 1500 - 250 - A - N | ~9,19 |
| LS 1500 - 300 - A | 300 | 710 | 410 | 0 | 1590 | 1139 | LS 1500 - 300 - A - N | ~11,04 |

Info pg. 229

LS 2400

- 50% VIBRATIONS
- 55% NOISE



Forza iniziale nulla - Zero force on contact - Ausgangsleistung Null
Force initiale nulle - Fuerza inicial cero - Força inicial nula

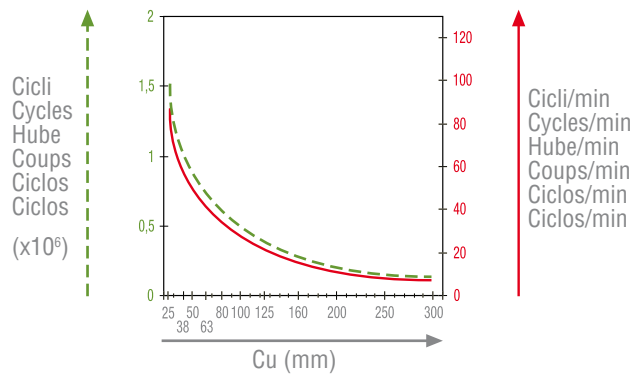
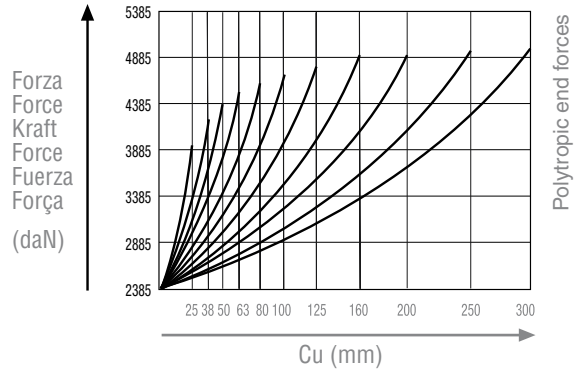
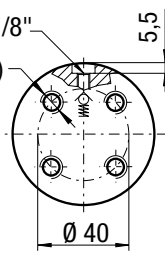
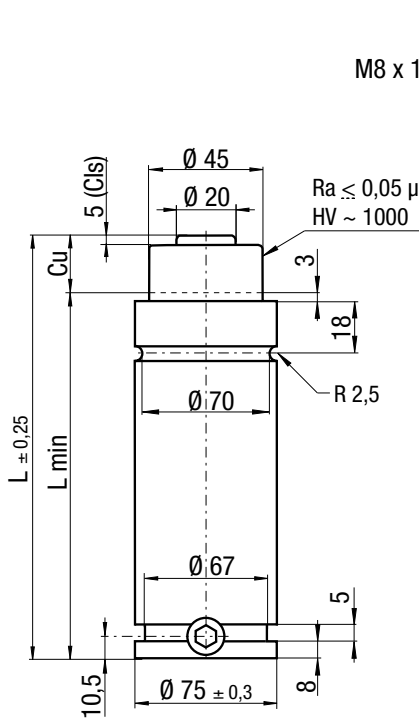

(10) LS 2400-050-A

ORDER (10) LS 2400-050-A-N



Fixings

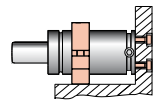
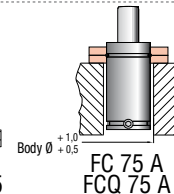
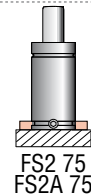
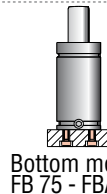
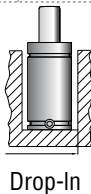

Body Ø +1.0
+0.5

Drop-in

Bottom mount
FB 75 - FBA 75

FS2 75
FS2A 75

Body Ø +1.0
+0.5
FC 75 A
FCQ 75 A

FSA 75

Max. Speed
1,8 m/s

°F 32
176
°C 0
80



P max
150 bar
2175 psi

P min
20 bar
290 psi

S
15,9
cm²



Maintenance kit
39BMLS01500A

Technical specifications

| Code | Cu mm | L mm | Lmin mm | F 0 at 150 bar/+20 °C daN | F Cls at 150 bar/+20 °C daN (±5%) | Vo cm ³ | connecting hole G1/8" Jic 37° hose Minimess hose | Kg |
|-------------------|----------|---------|------------|---------------------------------|---|-----------------------|---|--------|
| LS 2400 - 025 - A | 25 | 160 | 135 | 0 | 2385 | 126 | LS 2400 - 025 - A - N | ~3,71 |
| LS 2400 - 038 - A | 38 | 186 | 148 | 0 | 2385 | 174 | LS 2400 - 038 - A - N | ~3,79 |
| LS 2400 - 050 - A | 50 | 210 | 160 | 0 | 2385 | 218 | LS 2400 - 050 - A - N | ~3,89 |
| LS 2400 - 063 - A | 63,5 | 237 | 173,5 | 0 | 2385 | 268 | LS 2400 - 063 - A - N | ~4,48 |
| LS 2400 - 080 - A | 80 | 270 | 190 | 0 | 2385 | 329 | LS 2400 - 080 - A - N | ~4,73 |
| LS 2400 - 100 - A | 100 | 310 | 210 | 0 | 2385 | 403 | LS 2400 - 100 - A - N | ~4,89 |
| LS 2400 - 125 - A | 125 | 360 | 235 | 0 | 2385 | 495 | LS 2400 - 125 - A - N | ~5,57 |
| LS 2400 - 160 - A | 160 | 430 | 270 | 0 | 2385 | 624 | LS 2400 - 160 - A - N | ~6,33 |
| LS 2400 - 200 - A | 200 | 510 | 310 | 0 | 2385 | 771 | LS 2400 - 200 - A - N | ~7,19 |
| LS 2400 - 250 - A | 250 | 610 | 360 | 0 | 2385 | 955 | LS 2400 - 250 - A - N | ~9,19 |
| LS 2400 - 300 - A | 300 | 710 | 410 | 0 | 2385 | 1139 | LS 2400 - 300 - A - N | ~11,04 |

Info pg. 229

Forza iniziale nulla - Zero force on contact - Ausgangsleistung Null -
Force initiale nulle - Fuerza inicial cero - Força inicial nula

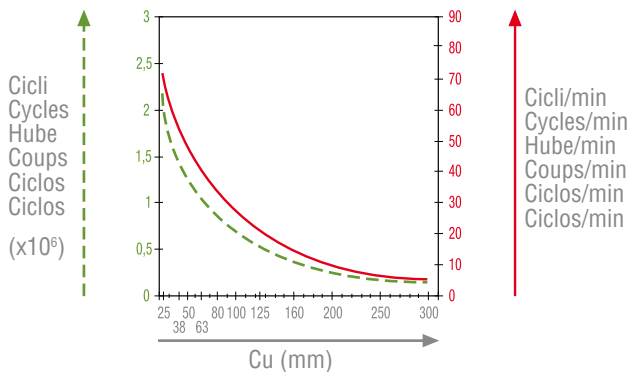
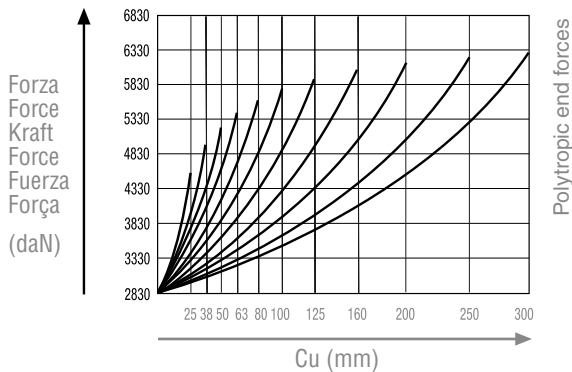
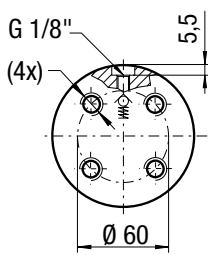
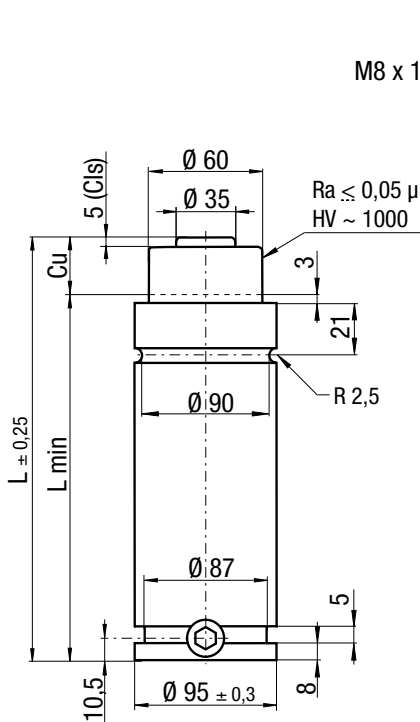

ORDER (10) LS 3000-050-A
 (10) LS 3000-050-A-N

Fixings: Drop-In, Bottom mount (FB 95 - FBA 95), FS2 95, FS2A 95, FC 95 A, FCQ 95 A, FSA 95

| | | | | | | | |
|------------------------------|------------------------|----------------------|----------------------|-------------------------------------|-----------------------------------|--------------------------------------|--|
| Max. Speed 1,8 m/s | °F 32 176 | °C 0 80 | N₂ | P max 100 bar 1450 psi | P min 20 bar 290 psi | S 28,27 cm ² | Maintenance kit 39BMLS03000A |
|------------------------------|------------------------|----------------------|----------------------|-------------------------------------|-----------------------------------|--------------------------------------|--|

Technical specifications

| Code | Cu | L | Lmin | F 0 at 100 bar/+20 °C daN | F Cls at 100 bar/+20 °C daN (±5%) | Vo cm ³ | connecting hole G1/8" Jic 37° hose Minimess hose | Kg |
|-------------------|------|-----|-------|---------------------------------|---|-----------------------|---|--------|
| LS 3000 - 025 - A | 25 | 170 | 145 | 0 | 2830 | 195 | LS 3000 - 025 - A - N | ~5,69 |
| LS 3000 - 038 - A | 38 | 196 | 158 | 0 | 2830 | 274 | LS 3000 - 038 - A - N | ~6,48 |
| LS 3000 - 050 - A | 50 | 220 | 170 | 0 | 2830 | 347 | LS 3000 - 050 - A - N | ~6,77 |
| LS 3000 - 063 - A | 63,5 | 247 | 183,5 | 0 | 2830 | 429 | LS 3000 - 063 - A - N | ~6,84 |
| LS 3000 - 080 - A | 80 | 280 | 200 | 0 | 2830 | 529 | LS 3000 - 080 - A - N | ~7,23 |
| LS 3000 - 100 - A | 100 | 320 | 220 | 0 | 2830 | 650 | LS 3000 - 100 - A - N | ~7,95 |
| LS 3000 - 125 - A | 125 | 370 | 245 | 0 | 2830 | 801 | LS 3000 - 125 - A - N | ~9,58 |
| LS 3000 - 160 - A | 160 | 440 | 280 | 0 | 2830 | 1013 | LS 3000 - 160 - A - N | ~10,89 |
| LS 3000 - 200 - A | 200 | 520 | 320 | 0 | 2830 | 1256 | LS 3000 - 200 - A - N | ~11,03 |
| LS 3000 - 250 - A | 250 | 620 | 370 | 0 | 2830 | 1559 | LS 3000 - 250 - A - N | ~12,06 |
| LS 3000 - 300 - A | 300 | 720 | 420 | 0 | 2830 | 1859 | LS 3000 - 300 - A - N | ~13,02 |

Info pg. 229

LS 4200

- 50% VIBRATIONS
- 55% NOISE



Forza iniziale nulla - Zero force on contact - Ausgangsleistung Null
Force initiale nulle - Fuerza inicial cero - Força inicial nula

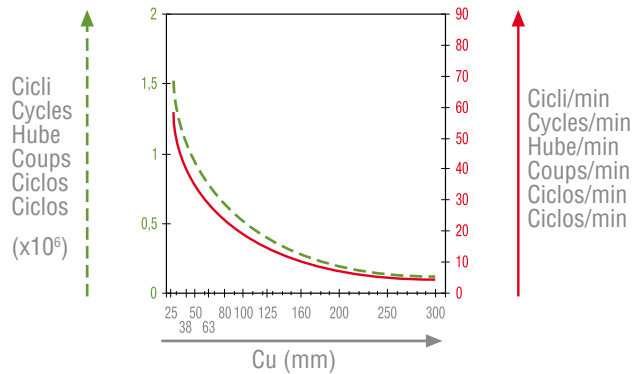
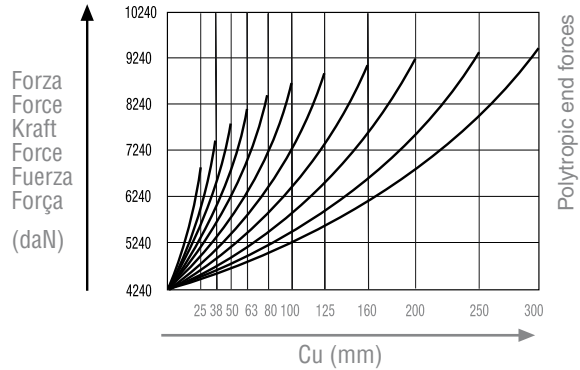
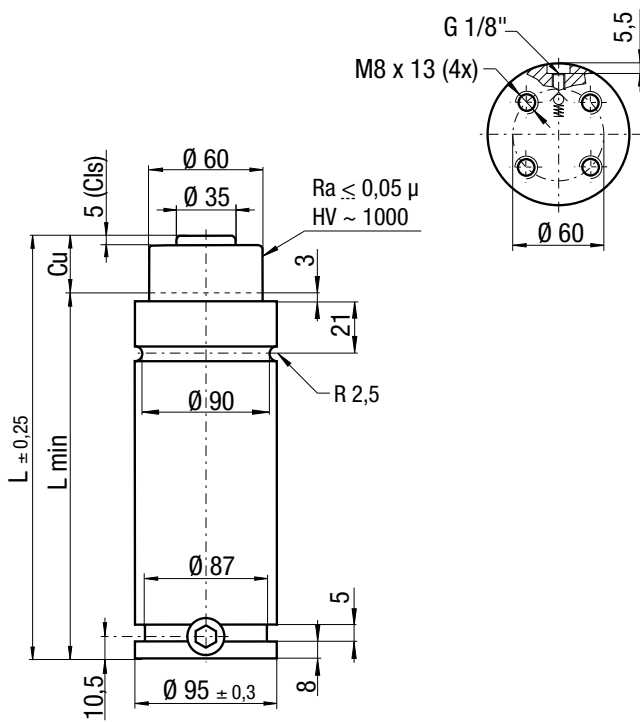

 (10) LS 4200-050-A
ORDER (10) LS 4200-050-A-N



Fixings

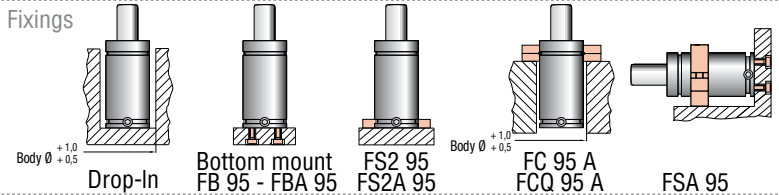

Max. Speed
1,8 m/s

°F 32
°C 0
176 80



P max
150 bar
2175 psi



P min
20 bar
290 psi

S
28,27
cm²



Maintenance kit
39BMLS03000A

Technical specifications

| Code | Cu mm | L mm | Lmin mm | F 0 at 150 bar/+20 °C daN | F Cls at 150 bar/+20 °C daN (±5%) | Vo cm ³ |  connecting hole G1/8" Jic 37° hose Minimess hose |  Kg |
|-------------------|----------|---------|------------|---------------------------------|---|-----------------------|---|--|
| LS 4200 - 025 - A | 25 | 170 | 145 | 0 | 4240 | 195 | LS 4200 - 025 - A - N | ~5,69 |
| LS 4200 - 038 - A | 38 | 196 | 158 | 0 | 4240 | 274 | LS 4200 - 038 - A - N | ~6,48 |
| LS 4200 - 050 - A | 50 | 220 | 170 | 0 | 4240 | 347 | LS 4200 - 050 - A - N | ~6,77 |
| LS 4200 - 063 - A | 63,5 | 247 | 183,5 | 0 | 4240 | 429 | LS 4200 - 063 - A - N | ~6,84 |
| LS 4200 - 080 - A | 80 | 280 | 200 | 0 | 4240 | 529 | LS 4200 - 080 - A - N | ~7,23 |
| LS 4200 - 100 - A | 100 | 320 | 220 | 0 | 4240 | 650 | LS 4200 - 100 - A - N | ~7,95 |
| LS 4200 - 125 - A | 125 | 370 | 245 | 0 | 4240 | 801 | LS 4200 - 125 - A - N | ~9,58 |
| LS 4200 - 160 - A | 160 | 440 | 280 | 0 | 4240 | 1013 | LS 4200 - 160 - A - N | ~10,89 |
| LS 4200 - 200 - A | 200 | 520 | 320 | 0 | 4240 | 1256 | LS 4200 - 200 - A - N | ~11,03 |
| LS 4200 - 250 - A | 250 | 620 | 370 | 0 | 4240 | 1559 | LS 4200 - 250 - A - N | ~12,06 |
| LS 4200 - 300 - A | 300 | 720 | 420 | 0 | 4240 | 1859 | LS 4200 - 300 - A - N | ~13,02 |

 Info pg. 229

Forza iniziale nulla - Zero force on contact - Ausgangsleistung Null -
Force initiale nulle - Fuerza inicial cero - Força inicial nula

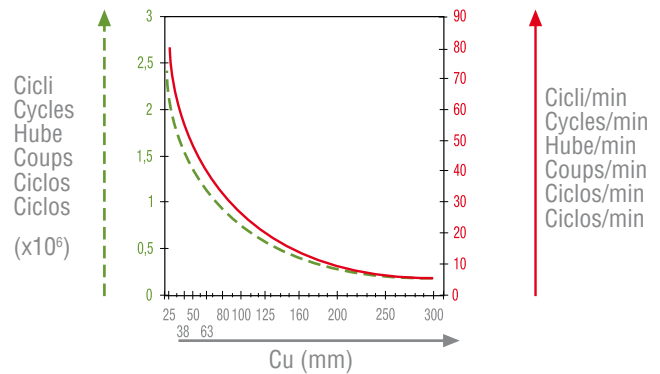
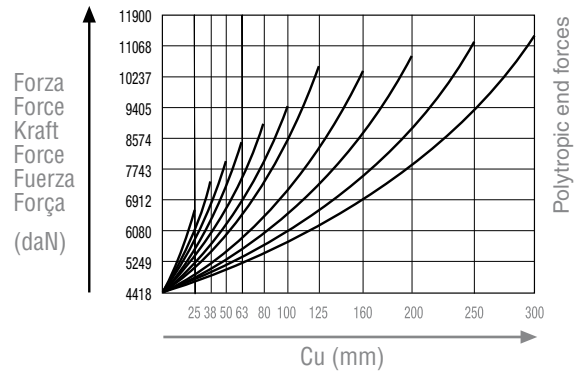
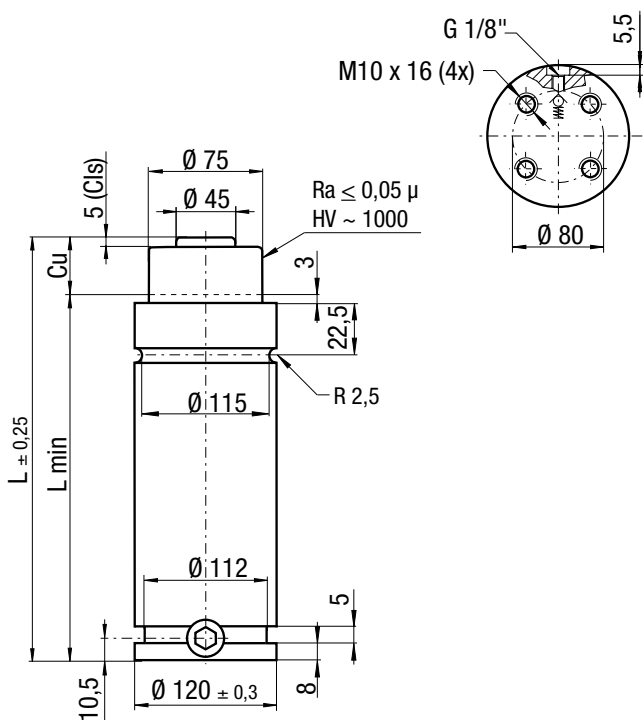

ORDER (10) LS 5000-050-A
(10) LS 5000-050-A-N

Fixings: Drop-In, Bottom mount (FB 120 - FBA 120), FS2 120 (FS2A 120), FC 120 A (FCQ 120 A), FSA 120.

LS

| | | | | | | | | |
|------------------------------|------------------------|----------------------|--|-------------------------------------|-----------------------------------|--------------------------------------|--|--|
| Max. Speed 1,8 m/s | °F 32 176 | °C 0 80 | | P max 100 bar 1450 psi | P min 20 bar 290 psi | S 44,18 cm ² | | Maintenance kit 39BMLS05000A |
|------------------------------|------------------------|----------------------|--|-------------------------------------|-----------------------------------|--------------------------------------|--|--|

Technical specifications

| Code | Cu mm | L mm | Lmin mm | F 0 at 100 bar/+20 °C daN | F Cls at 100 bar/+20 °C daN (±5%) | Vo cm ³ | connecting hole G1/8" Jic 37° hose Minimesse hose | Kg |
|-------------------|----------|---------|------------|---------------------------------|---|-----------------------|--|-------|
| LS 5000 - 025 - A | 25 | 190 | 165 | 0 | 4418 | 353 | LS 5000 - 025 - A - N | ~10,6 |
| LS 5000 - 038 - A | 38 | 216 | 178 | 0 | 4418 | 471 | LS 5000 - 038 - A - N | ~12,0 |
| LS 5000 - 050 - A | 50 | 240 | 190 | 0 | 4418 | 580 | LS 5000 - 050 - A - N | ~13,2 |
| LS 5000 - 063 - A | 63,5 | 267 | 203,5 | 0 | 4418 | 697 | LS 5000 - 063 - A - N | ~13,6 |
| LS 5000 - 080 - A | 80 | 300 | 220 | 0 | 4418 | 851 | LS 5000 - 080 - A - N | ~14,1 |
| LS 5000 - 100 - A | 100 | 340 | 240 | 0 | 4418 | 1032 | LS 5000 - 100 - A - N | ~15,4 |
| LS 5000 - 125 - A | 125 | 390 | 265 | 0 | 4418 | 1259 | LS 5000 - 125 - A - N | ~16,9 |
| LS 5000 - 160 - A | 160 | 460 | 300 | 0 | 4418 | 1575 | LS 5000 - 160 - A - N | ~18,7 |
| LS 5000 - 200 - A | 200 | 540 | 340 | 0 | 4418 | 1937 | LS 5000 - 200 - A - N | ~21,7 |
| LS 5000 - 250 - A | 250 | 640 | 390 | 0 | 4418 | 2390 | LS 5000 - 250 - A - N | ~24,8 |
| LS 5000 - 300 - A | 300 | 740 | 440 | 0 | 4418 | 2843 | LS 5000 - 300 - A - N | ~28,0 |

Info pg. 229

LS 6600

- 50% VIBRATIONS
- 55% NOISE



Forza iniziale nulla - Zero force on contact - Ausgangsleistung Null - Force initiale nulle - Fuerza inicial cero - Força inicial nula

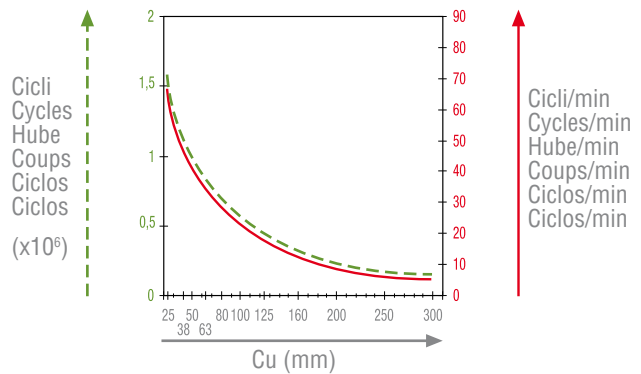
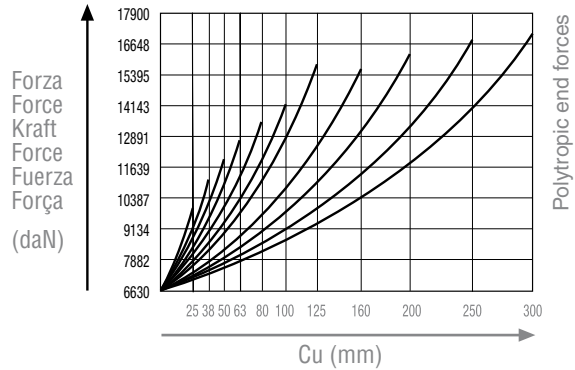
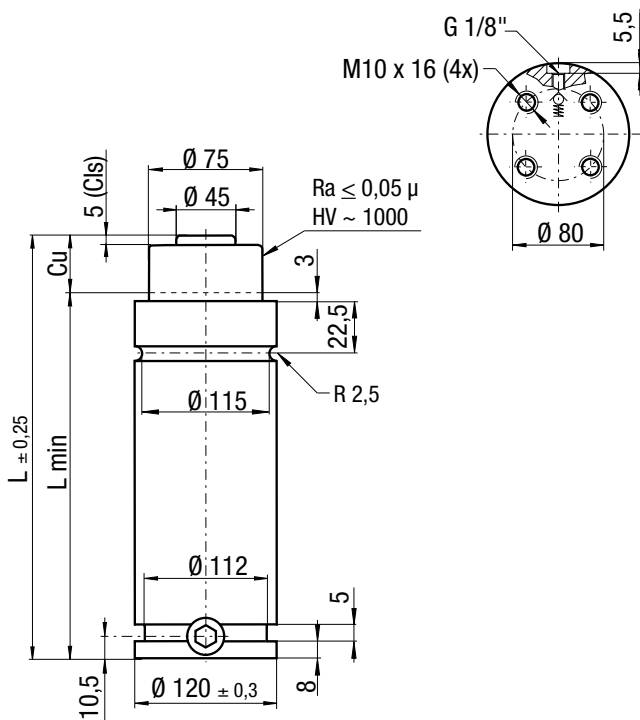

ORDER (10) LS 6600-050-A
ORDER (10) LS 6600-050-A-N

Fixings: Drop-In, Bottom mount FB 120 - FBA 120, FS2 120 FS2A 120, FC 120 A FCQ 120 A, FSA 120

| | | | | | | | |
|-----------------------|-------------------------|----------------|------------------------------|----------------------------|-------------------------------|--|---------------------------------|
| Max. Speed 1,8 m/s | °F 32 °C 0 176 80 | N ₂ | P max 150 bar 2175 psi | P min 20 bar 290 psi | S 44,18 cm ² | | Maintenance kit 39BMLS05000A |
|-----------------------|-------------------------|----------------|------------------------------|----------------------------|-------------------------------|--|---------------------------------|

Technical specifications

| Code | Cu mm | L mm | Lmin mm | F 0 at 150 bar/+20 °C daN | F Cls at 150 bar/+20 °C daN (±5%) | V ₀ cm ³ | connecting hole G1/8" Jic 37° hose Minimess hose | Kg |
|-------------------|----------|---------|------------|---------------------------------|---|-----------------------------------|---|-------|
| LS 6600 - 025 - A | 25 | 190 | 165 | 0 | 6630 | 353 | LS 6600 - 025 - A - N | ~10,6 |
| LS 6600 - 038 - A | 38 | 216 | 178 | 0 | 6630 | 471 | LS 6600 - 038 - A - N | ~12,0 |
| LS 6600 - 050 - A | 50 | 240 | 190 | 0 | 6630 | 580 | LS 6600 - 050 - A - N | ~13,2 |
| LS 6600 - 063 - A | 63,5 | 267 | 203,5 | 0 | 6630 | 697 | LS 6600 - 063 - A - N | ~13,6 |
| LS 6600 - 080 - A | 80 | 300 | 220 | 0 | 6630 | 851 | LS 6600 - 080 - A - N | ~14,1 |
| LS 6600 - 100 - A | 100 | 340 | 240 | 0 | 6630 | 1032 | LS 6600 - 100 - A - N | ~15,4 |
| LS 6600 - 125 - A | 125 | 390 | 265 | 0 | 6630 | 1259 | LS 6600 - 125 - A - N | ~16,9 |
| LS 6600 - 160 - A | 160 | 460 | 300 | 0 | 6630 | 1575 | LS 6600 - 160 - A - N | ~18,7 |
| LS 6600 - 200 - A | 200 | 540 | 340 | 0 | 6630 | 1937 | LS 6600 - 200 - A - N | ~21,7 |
| LS 6600 - 250 - A | 250 | 640 | 390 | 0 | 6630 | 2390 | LS 6600 - 250 - A - N | ~24,8 |
| LS 6600 - 300 - A | 300 | 740 | 440 | 0 | 6630 | 2843 | LS 6600 - 300 - A - N | ~28,0 |

Info pg. 229

Forza iniziale nulla - Zero force on contact - Ausgangsleistung Null -
Force initiale nulle - Fuerza inicial cero - Força inicial nula

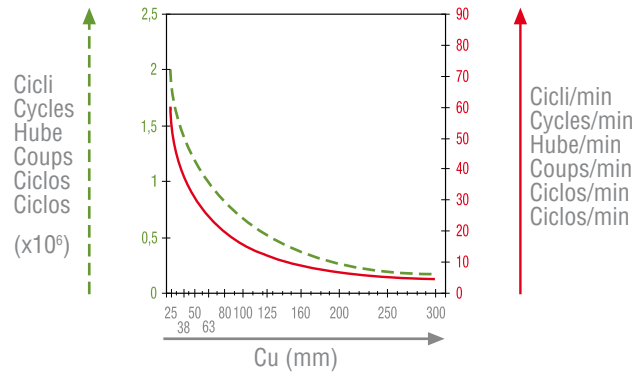
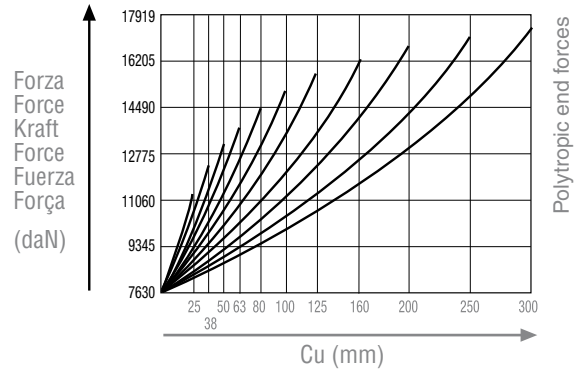
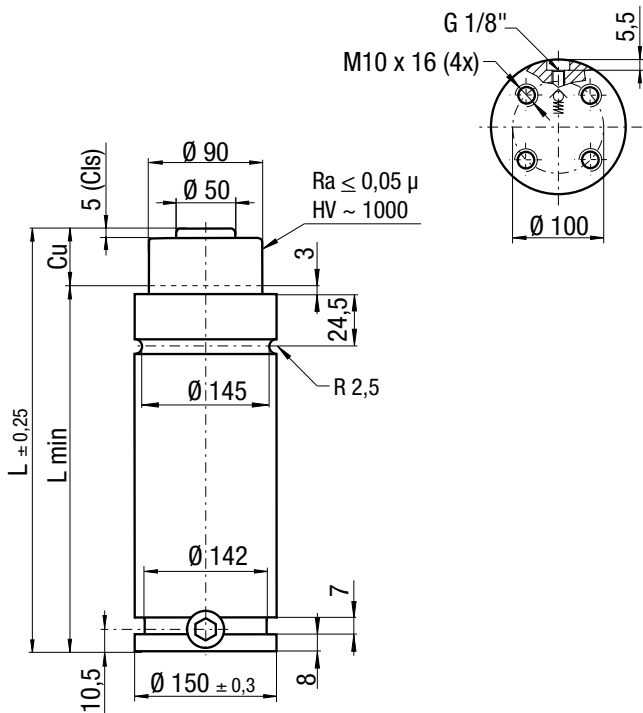

ORDER (10) LS 7500-050-A
(10) LS 7500-050-A-N

Fixings

Drop-In, Bottom mount, FS2 150, FC 150 A, FSA 150

| | | | | | | | | |
|------------------------------|------------------------|----------------------|----------------|-------------------------------------|-----------------------------------|--------------------------------------|--|--|
| Max. Speed 1,8 m/s | °F 32 176 | °C 0 80 | N ₂ | P max 120 bar 1740 psi | P min 20 bar 290 psi | S 63,61 cm ² | | Maintenance kit 39BMLS07500A |
|------------------------------|------------------------|----------------------|----------------|-------------------------------------|-----------------------------------|--------------------------------------|--|--|

Technical specifications

| Code | Cu | L | Lmin | F 0 | F Cls | Vo | connecting hole G1/8" | Kg |
|-------------------|------|-----|-------|--------------------------|--------------------------------|-----------------|--------------------------------|--------|
| | mm | mm | mm | at 120 bar/+20 °C daN | at 120 bar/+20 °C daN (±5%) | cm ³ | Jic 37° hose Minimesse hose | |
| LS 7500 - 025 - A | 25 | 205 | 180 | 0 | 7630 | 654 | LS 7500 - 025 - A - N | ~19.95 |
| LS 7500 - 038 - A | 38 | 231 | 193 | 0 | 7630 | 839 | LS 7500 - 038 - A - N | ~21.15 |
| LS 7500 - 050 - A | 50 | 255 | 205 | 0 | 7630 | 1010 | LS 7500 - 050 - A - N | ~21.95 |
| LS 7500 - 063 - A | 63,5 | 282 | 218,5 | 0 | 7630 | 1195 | LS 7500 - 063 - A - N | ~22.75 |
| LS 7500 - 080 - A | 80 | 315 | 235 | 0 | 7630 | 1437 | LS 7500 - 080 - A - N | ~24.55 |
| LS 7500 - 100 - A | 100 | 355 | 255 | 0 | 7630 | 1723 | LS 7500 - 100 - A - N | ~26.25 |
| LS 7500 - 125 - A | 125 | 405 | 280 | 0 | 7630 | 2079 | LS 7500 - 125 - A - N | ~28.15 |
| LS 7500 - 160 - A | 160 | 475 | 315 | 0 | 7630 | 2587 | LS 7500 - 160 - A - N | ~31.55 |
| LS 7500 - 200 - A | 200 | 555 | 355 | 0 | 7630 | 3148 | LS 7500 - 200 - A - N | ~35.15 |
| LS 7500 - 250 - A | 250 | 655 | 405 | 0 | 7630 | 3861 | LS 7500 - 250 - A - N | ~38.65 |
| LS 7500 - 300 - A | 300 | 755 | 455 | 0 | 7630 | 4573 | LS 7500 - 300 - A - N | ~42.55 |

Info pg. 229

LS 9500

- 50% VIBRATIONS
- 55% NOISE



Forza iniziale nulla - Zero force on contact - Ausgangsleistung Null - Force initiale nulle - Fuerza inicial cero - Força inicial nula

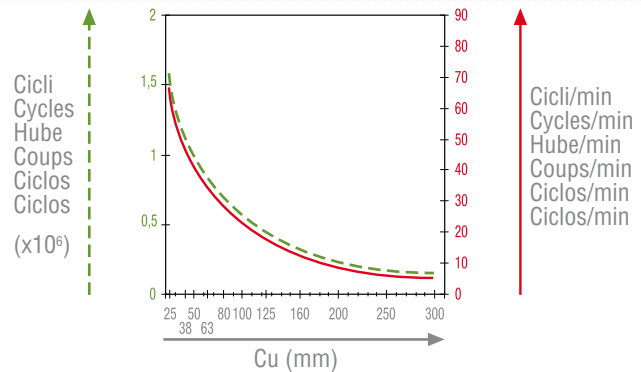
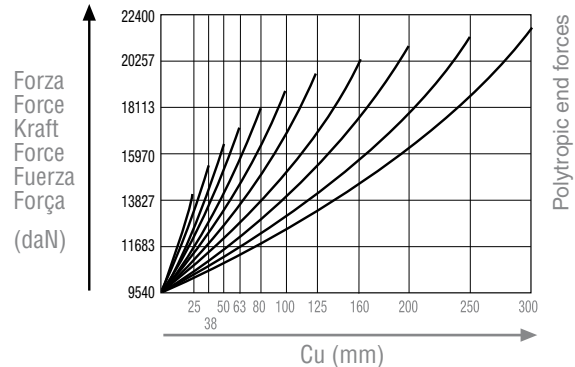
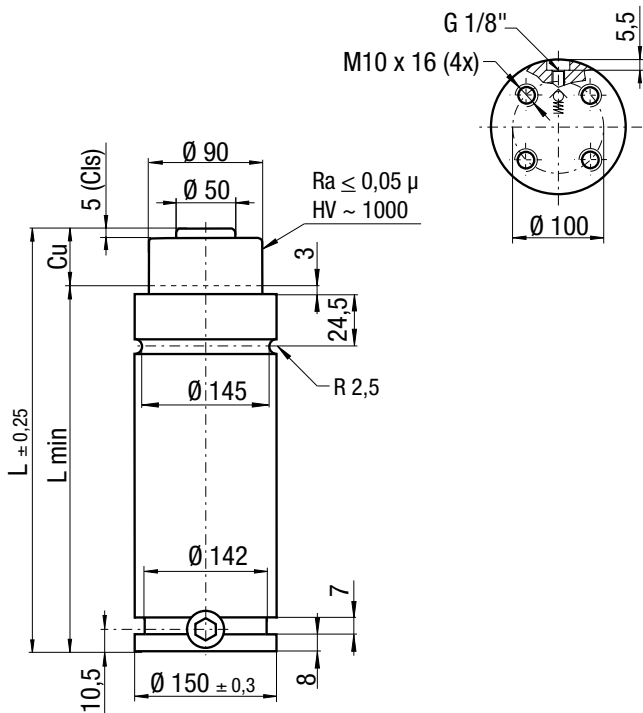

(10) LS 9500-050-A

ORDER (10) LS 9500-050-A-N



Fixings

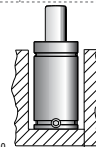

Drop-In

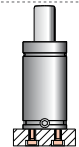

Bottom mount
FB 150 - FBA 150

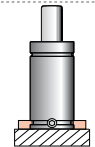

FS2 150
FS2A 150

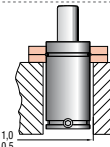

FC 150 A
FCQ 150 A

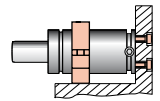

FSA 150

Max. Speed
1,8 m/s

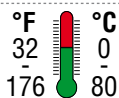

P max
150 bar
2175 psi

P min
20 bar
290 psi

S
63,61
cm²



Maintenance kit
39BMLS07500A

Technical specifications

| Code | Cu | L | Lmin | F 0 at 150 bar/+20 °C daN | F Cis at 150 bar/+20 °C daN (±5%) | Vo | connecting hole G1/8" Jic 37° hose Minimess hose | Kg |
|-------------------|------|-----|-------|---------------------------------|---|-----------------|---|--------|
| | mm | mm | mm | | | cm ³ | | |
| LS 9500 - 025 - A | 25 | 205 | 180 | 0 | 9540 | 654 | LS 9500 - 025 - A - N | ~19.95 |
| LS 9500 - 038 - A | 38 | 231 | 193 | 0 | 9540 | 839 | LS 9500 - 038 - A - N | ~21.15 |
| LS 9500 - 050 - A | 50 | 255 | 205 | 0 | 9540 | 1010 | LS 9500 - 050 - A - N | ~21.95 |
| LS 9500 - 063 - A | 63,5 | 282 | 218,5 | 0 | 9540 | 1195 | LS 9500 - 063 - A - N | ~22.75 |
| LS 9500 - 080 - A | 80 | 315 | 235 | 0 | 9540 | 1437 | LS 9500 - 080 - A - N | ~24.55 |
| LS 9500 - 100 - A | 100 | 355 | 255 | 0 | 9540 | 1723 | LS 9500 - 100 - A - N | ~26.25 |
| LS 9500 - 125 - A | 125 | 405 | 280 | 0 | 9540 | 2079 | LS 9500 - 125 - A - N | ~28.15 |
| LS 9500 - 160 - A | 160 | 475 | 315 | 0 | 9540 | 2587 | LS 9500 - 160 - A - N | ~31.55 |
| LS 9500 - 200 - A | 200 | 555 | 355 | 0 | 9540 | 3148 | LS 9500 - 200 - A - N | ~35.15 |
| LS 9500 - 250 - A | 250 | 655 | 405 | 0 | 9540 | 3861 | LS 9500 - 250 - A - N | ~38.65 |
| LS 9500 - 300 - A | 300 | 755 | 455 | 0 | 9540 | 4573 | LS 9500 - 300 - A - N | ~42.55 |

Info pg. 229