

ISO Standard, forza potenziata - ISO Standard, high force - Standard ISO, erhöhte Leistung
 Standard ISO, force majorée - ISO Standard, fuerza potenciada -
 Norma ISO, força permitida

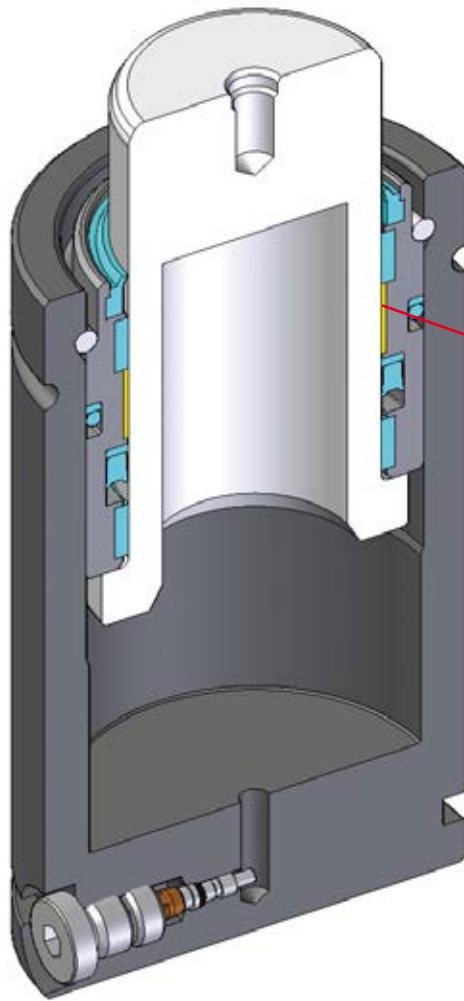

Permanent
Lubrication
 on the
Rod

Range chart

Model	Body Ø mm	Stroke Cu mm	Initial force daN			
				SKUDO	OSAS	OPAS
H 300	32	10 - 125	300	-	✓	-
H 500	38	10 - 125	470	-	✓	-
HF 500	M 38 X 1,5	10 - 125	470	-	✓	-
H 700	45	13 - 160	680	-	-	-
HF 700	M 45 X 1,5	13 - 160	680	-	-	-
H 1000	50	13 - 300	1060	-	-	-
HF 1000	M 50 X 1,5	13 - 300	1060	-	-	-
H 2400	75	25 - 300	2385	-	-	-
H 4200	95	25 - 300	4240	-	-	-
H 6600	120	25 - 300	6630	-	-	-
H 18500	195	25 - 300	18400	-	-	-

ISO Standard, forza potenziata - ISO Standard, high force - Standard ISO, erhöhte Leistung Standard ISO, force majorée - ISO Standard, fuerza potenciada - Norma ISO, forța permitida

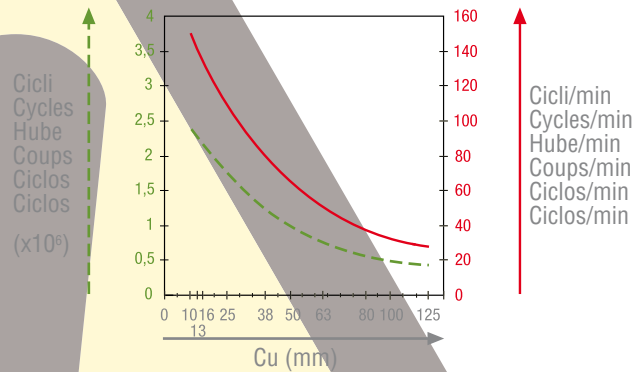
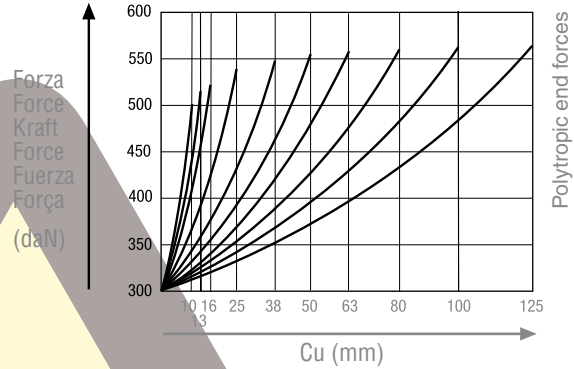
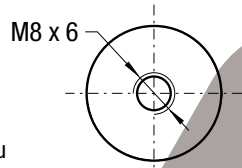
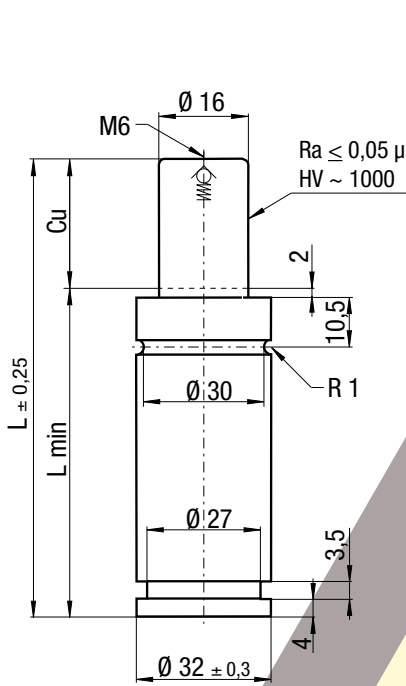

H
HF

(10) H 300-050-B

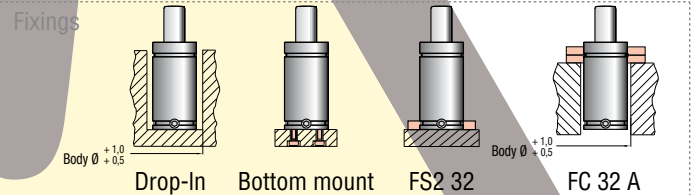

Max. Speed 1,8 m/s	°F 32 176	°C 0 80		P max 150 bar 2175 psi	P min 20 bar 290 psi	S 2,01 cm ²		Maintenance kit 39BMH00300B
------------------------------	------------------------	----------------------	--	-------------------------------------	-----------------------------------	-------------------------------------	--	---------------------------------------

Technical specifications

Code	Cu mm	L mm	Lmin mm	Fo at 150 bar/+20 °C daN (±5%)	Vo cm ³		
H 300 - 010 - B	10	70	60	300	-	-	~0,29
H 300 - 013 - B	13	75,4	62,7	300	-	-	~0,30
H 300 - 016 - B	16	82	66	300	-	-	~0,31
H 300 - 025 - B	25	100	75	300	-	-	~0,34
H 300 - 038 - B	38	126	88	300	-	-	~0,38
H 300 - 050 - B	50	150	100	300	-	-	~0,43
H 300 - 063 - B	63	177	113,5	300	-	-	~0,48
H 300 - 080 - B	80	210	130	300	-	-	~0,54
H 300 - 100 - B	100	250	150	300	-	-	~0,61
H 300 - 125 - B	125	300	175	300	-	-	~0,69

ISO Standard, forza potenziata - ISO Standard, high force - Standard ISO, erhöhte Leistung - Standard ISO, force majorée - ISO Standard, fuerza potenciada - Norma ISO, força permitida

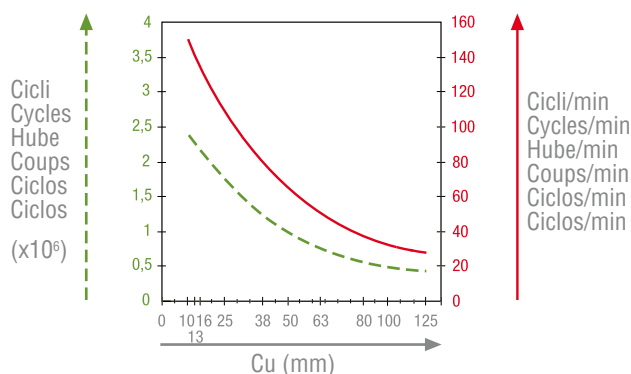
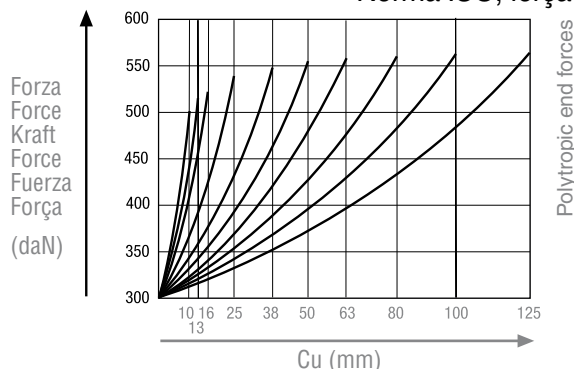
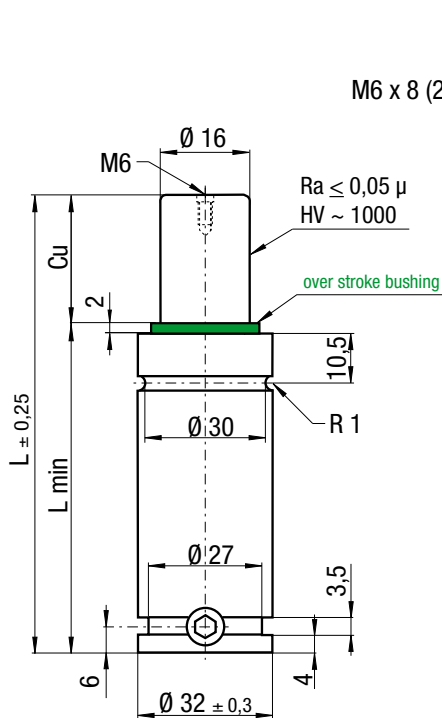

(10) H 300-050-C
ORDER (10) H 300-050-C-N



Fixings

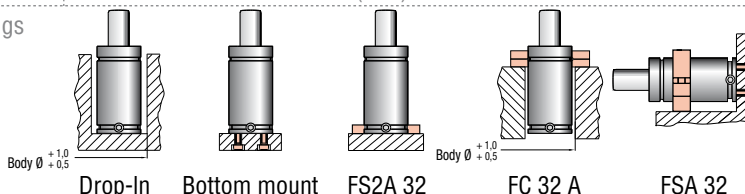

Max. Speed
1,8 m/s

°F 32
176
°C 0
80



P max
150 bar
2175 psi

P min
20 bar
290 psi

S
2,01
cm²



Maintenance kit
39BMRV00350A



Technical specifications

Code	Cu	L	Lmin	F ₀ at 150 bar/+20 °C daN (±5%)	V ₀ cm ³	connecting hole M6 Micro hose	Kg
NEW	mm	mm	mm				
H 300 - 010 - C	10	70	60	300	6,6	H 300 - 010 - C - N	~0,29
H 300 - 013 - C	13	75,7	62,7	300	8,2	H 300 - 013 - C - N	~0,30
H 300 - 016 - C	16	82	66	300	9,9	H 300 - 016 - C - N	~0,31
H 300 - 025 - C	25	100	75	300	15	H 300 - 025 - C - N	~0,34
H 300 - 038 - C	38	126	88	300	22,2	H 300 - 038 - C - N	~0,38
H 300 - 050 - C	50	150	100	300	28,9	H 300 - 050 - C - N	~0,43
H 300 - 063 - C	63	176,5	113,5	300	36,2	H 300 - 063 - C - N	~0,48
H 300 - 080 - C	80	210	130	300	45,7	H 300 - 080 - C - N	~0,54
H 300 - 100 - C	100	250	150	300	56,9	H 300 - 100 - C - N	~0,61
H 300 - 125 - C	125	300	175	300	70,9	H 300 - 125 - C - N	~0,69

Info pg. 229



ISO Standard, forza potenziata - ISO Standard, high force - Standard ISO,
 erhöhte Leistung - Standard ISO, force majorée - ISO Standard, fuerza potenciada -
 Norma ISO, força permitida

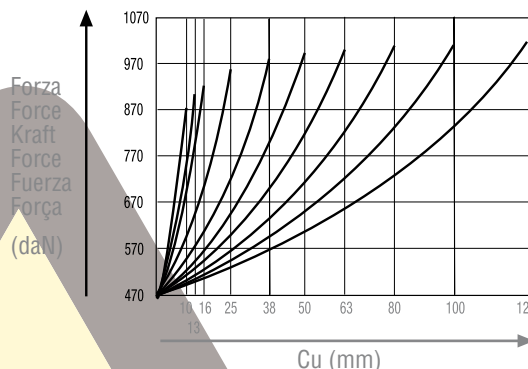
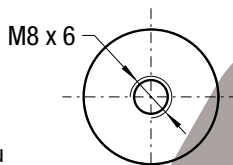
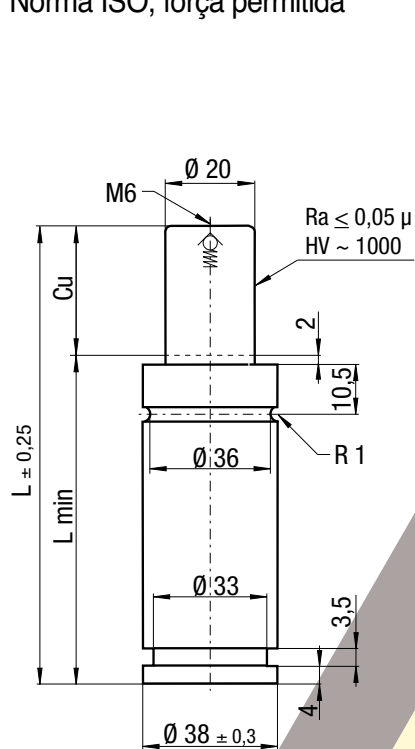

Polytropic end forces

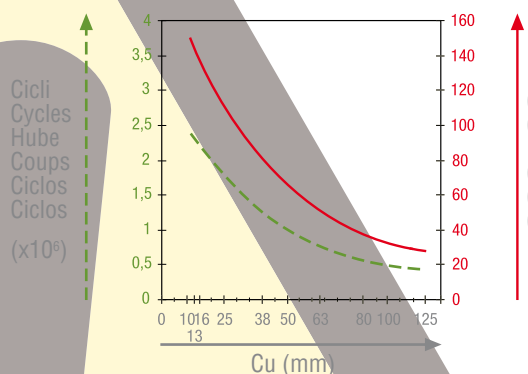

Cicli/min
 Cycles/min
 Hubs/min
 Coups/min
 Ciclos/min
 Ciclos/min

H
 HF



(10) H 500-050-B

Fixings

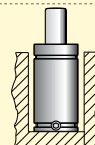

Drop-In

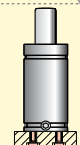

Bottom mount

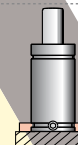

FS2 38

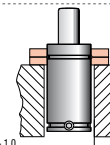

FC 38 A
 FCQ 38 A

Max. Speed
 1,8 m/s

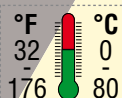

P max
 150 bar
 2175 psi

P min
 20 bar
 290 psi

S
 3,14
 cm²



Maintenance kit
 39BMH00500B

Technical specifications

Code	Cu mm	L mm	Lmin mm	Fo at 150 bar/+20 °C daN (±5%)	Vo cm ³		 Kg
H 500 - 010 - B	10	70	60	470	-	-	~0,42
H 500 - 013 - B	13	75,4	62,7	470	-	-	~0,43
H 500 - 016 - B	16	82	66	470	-	-	~0,45
H 500 - 025 - B	25	100	75	470	-	-	~0,50
H 500 - 038 - B	38	126	88	470	-	-	~0,56
H 500 - 050 - B	50	150	100	470	-	-	~0,63
H 500 - 063 - B	63	177	113,5	470	-	-	~0,70
H 500 - 080 - B	80	210	130	470	-	-	~0,79
H 500 - 100 - B	100	250	150	470	-	-	~0,89
H 500 - 125 - B	125	300	175	470	-	-	~1,08

H 500

PEO
97/23/EC



ISO Standard, forza potenziata - ISO Standard, high force - Standard ISO, erhöhte Leistung - Standard ISO, force majorée - ISO Standard, fuerza potenciada - Norma ISO, força permitida

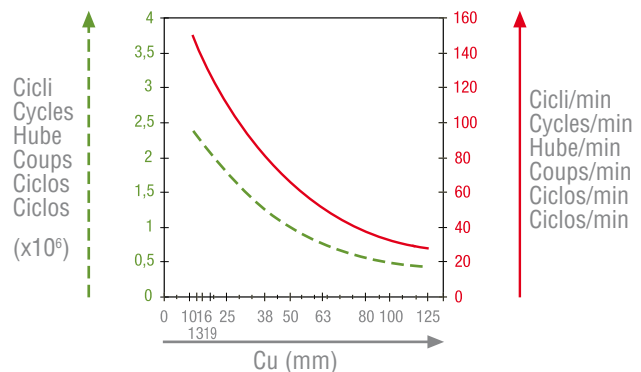
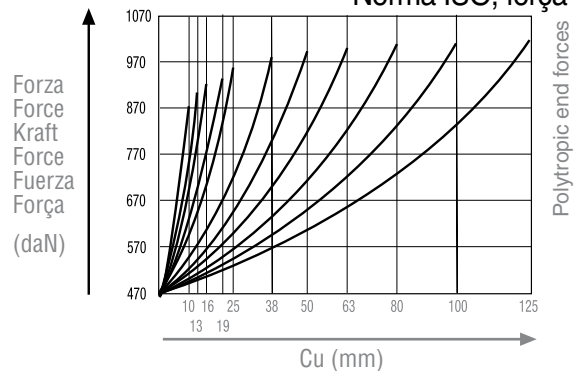
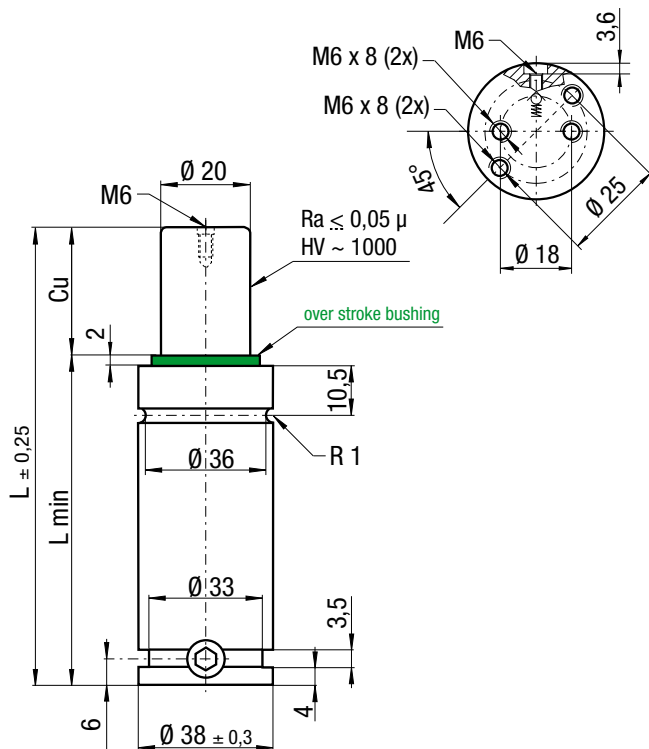

ORDER (10) H 500-050-C - N

Fixings: Drop-In, Bottom mount, FS2A 38, FC 38 A, FCQ 38 A, FSA 38

Max. Speed: 1,8 m/s

Temperature: 32 °F / 0 °C to 176 °F / 80 °C

Gas: N₂

P max: 150 bar / 2175 psi

P min: 20 bar / 290 psi

S: 3,14 cm²

Maintenance kit: 39BMRV00500A

lifeplus concept

Technical specifications

Code	Cu	L	Lmin	F ₀ at 150 bar/+20 °C daN (±5%)	V ₀ cm ³	connecting hole M6 Micro hose	Kg
NEW	mm	mm	mm				
H 500 - 010 - C	10	70	60	470	8,7	H 500 - 010 - C - N	~0,42
H 500 - 013 - C	13	75,7	62,7	470	10,9	H 500 - 013 - C - N	~0,43
H 500 - 016 - C	16	82	66	470	13,1	H 500 - 016 - C - N	~0,45
H 500 - 019 - C	19	88	69	470	16,2	H 500 - 019 - C - N	~0,48
H 500 - 025 - C	25	100	75	470	19,7	H 500 - 025 - C - N	~0,50
H 500 - 038 - C	38	126	88	470	29,3	H 500 - 038 - C - N	~0,56
H 500 - 050 - C	50	150	100	470	38,1	H 500 - 050 - C - N	~0,63
H 500 - 063 - C	63	176,5	113,5	470	47,6	H 500 - 063 - C - N	~0,70
H 500 - 080 - C	80	210	130	470	60,1	H 500 - 080 - C - N	~0,79
H 500 - 100 - C	100	250	150	470	74,6	H 500 - 100 - C - N	~0,89
H 500 - 125 - C	125	300	175	470	93,2	H 500 - 125 - C - N	~1,08

Info pg. 229

ISO Standard, forza potenziata - ISO Standard, high force - Standard ISO,
erhöhte Leistung - Standard ISO, force majorée - ISO Standard, fuerza potenciada -
Norma ISO, força permitida

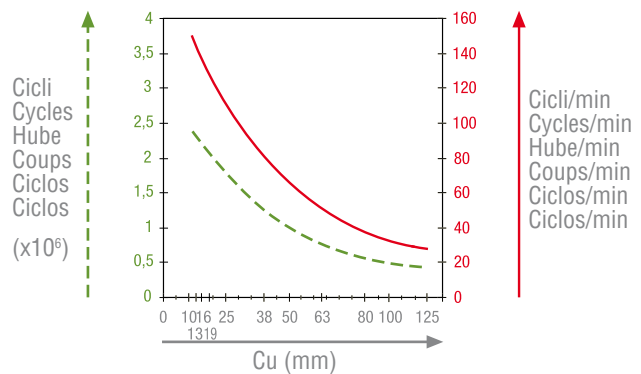
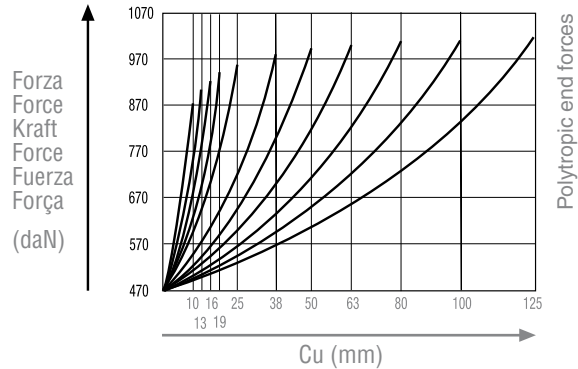
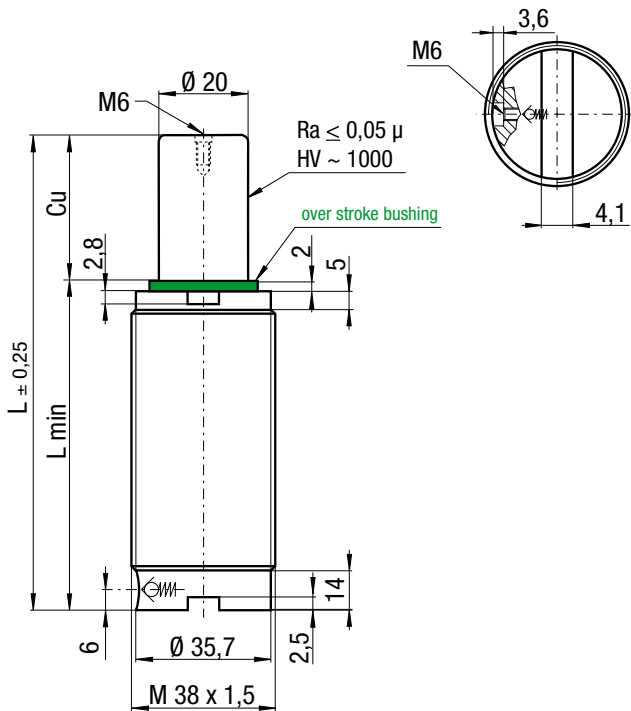

HF

(10) HF 500-050-C
ORDER (10) HF 500-050-C-N



Fixings

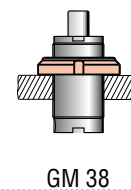
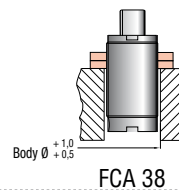

Max. Speed
1,8 m/s

°F 32
176

°C 0
80



P max
150 bar
2175 psi

P min
20 bar
290 psi

S
3,14
cm²



Maintenance kit
39BMRV00500A



Technical specifications

Code		Cu	L	Lmin	F ₀	V ₀	connecting hole M6	Kg
PHASING OUT	NEW	mm	mm	mm	at 150 bar/+20 °C daN (±5%)	cm ³	Micro hose	
HF 500 - 010 - A	HF 500 - 010 - C	10	70	60	470	8,7	HF 500 - 010 - C - N	~0,39
HF 500 - 013 - A	HF 500 - 013 - C	13	75,7	62,7	470	10,9	HF 500 - 013 - C - N	~0,40
HF 500 - 016 - A	HF 500 - 016 - C	16	82	66	470	13,1	HF 500 - 016 - C - N	~0,42
-	HF 500 - 019 - C	19	88	69	470	16,2	HF 500 - 019 - C - N	~0,45
HF 500 - 025 - A	HF 500 - 025 - C	25	100	75	470	19,7	HF 500 - 025 - C - N	~0,48
HF 500 - 038 - A	HF 500 - 038 - C	38	126	88	470	29,3	HF 500 - 038 - C - N	~0,54
HF 500 - 050 - A	HF 500 - 050 - C	50	150	100	470	38,1	HF 500 - 050 - C - N	~0,59
HF 500 - 063 - A	HF 500 - 063 - C	63	176,5	113,5	470	47,6	HF 500 - 063 - C - N	~0,66
HF 500 - 080 - A	HF 500 - 080 - C	80	210	130	470	60,1	HF 500 - 080 - C - N	~0,76
HF 500 - 100 - A	HF 500 - 100 - C	100	250	150	470	74,6	HF 500 - 100 - C - N	~0,85
HF 500 - 125 - A	HF 500 - 125 - C	125	300	175	470	93,2	HF 500 - 125 - C - N	~1,05

Info pg. 229

ISO Standard, forza potenziata - ISO Standard, high force - Standard ISO, erhöhte Leistung - Standard ISO, force majorée - ISO Standard, fuerza potenciada - Norma ISO, força permitida

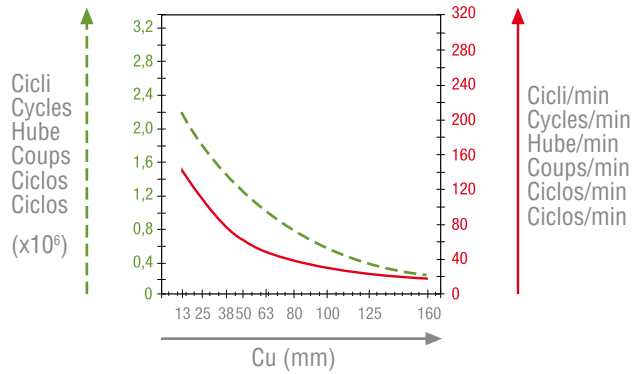
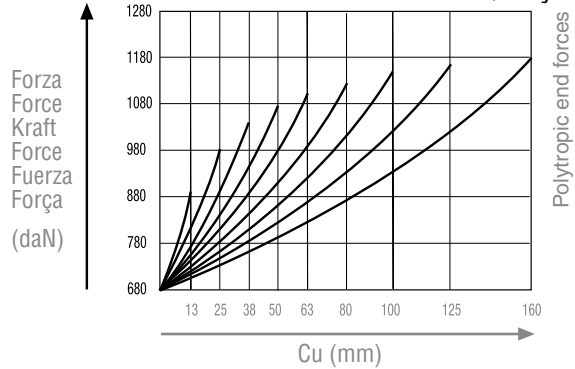
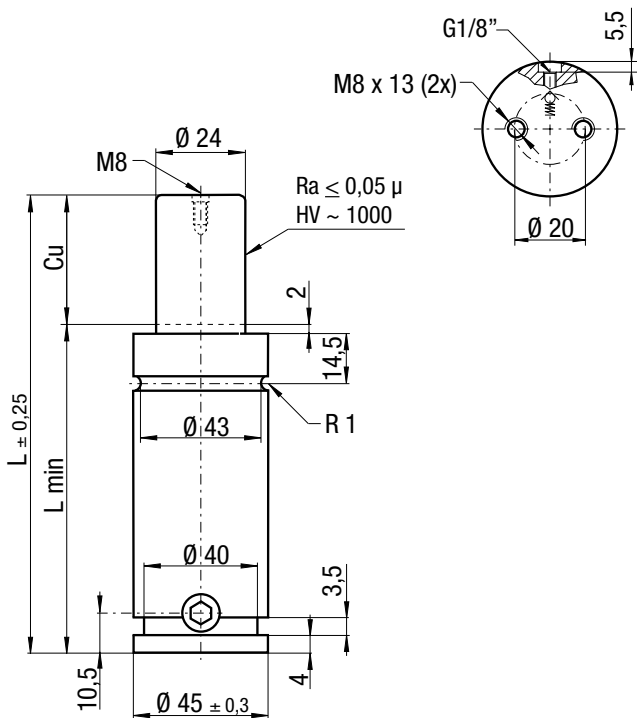

ORDER (10) H 700-050-A
 (10) H 700-050-A-N

Fixings: Drop-In, Bottom mount FB 45 - FBA 45, FS2 45 FS2A 45, FC 45 A FCQ 45 A, FSA 45

Max. Speed 1,8 m/s	°F 32 176	°C 0 80	N ₂	P max 150 bar 2175 psi	P min 20 bar 290 psi	S 4,52 cm ²		Maintenance kit 39BMH00700A
------------------------------	------------------------	----------------------	----------------	-------------------------------------	-----------------------------------	-------------------------------------	--	---------------------------------------

Technical specifications

Code	Cu mm	L mm	Lmin mm	F ₀ at 150 bar/+20 °C daN (±5%)	V ₀ cm ³	connecting hole G1/8" Jic 37° hose Minimess hose	Kg
H 700 - 013 - A	12,7	110,4	97,7	680	31	H 700 - 013 - A - N	~0,98
H 700 - 025 - A	25	135	110	680	46	H 700 - 025 - A - N	~1,07
H 700 - 038 - A	38	161	123	680	62	H 700 - 038 - A - N	~1,16
H 700 - 050 - A	50	185	135	680	76	H 700 - 050 - A - N	~1,25
H 700 - 063 - A	63,5	212	148,5	680	93	H 700 - 063 - A - N	~1,35
H 700 - 080 - A	80	245	165	680	113	H 700 - 080 - A - N	~1,47
H 700 - 100 - A	100	285	185	680	137	H 700 - 100 - A - N	~1,72
H 700 - 125 - A	125	335	210	680	167	H 700 - 125 - A - N	~1,80
H 700 - 160 - A	160	405	245	680	210	H 700 - 160 - A - N	~2,05

Info pg. 229

ISO Standard, forza potenziata - ISO Standard, high force - Standard ISO,
 erhöhte Leistung - Standard ISO, force majorée - ISO Standard, fuerza potenciada -
 Norma ISO, força permitida

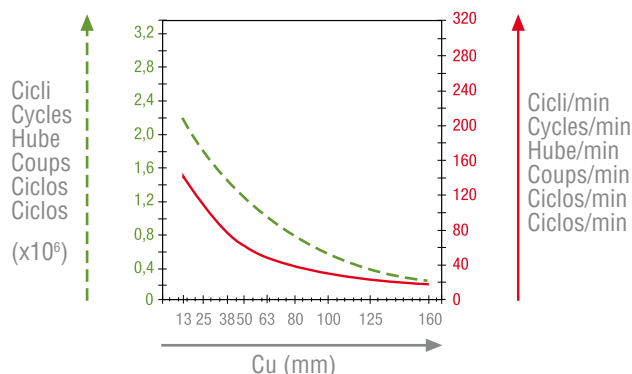
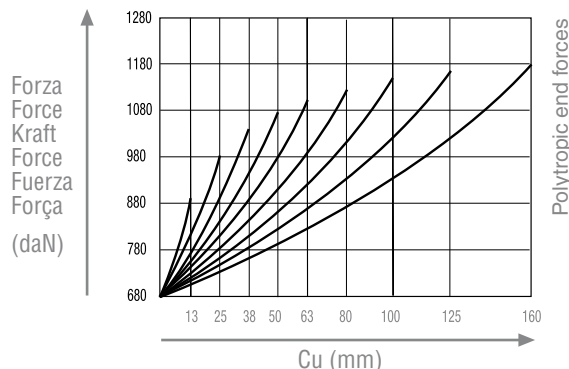
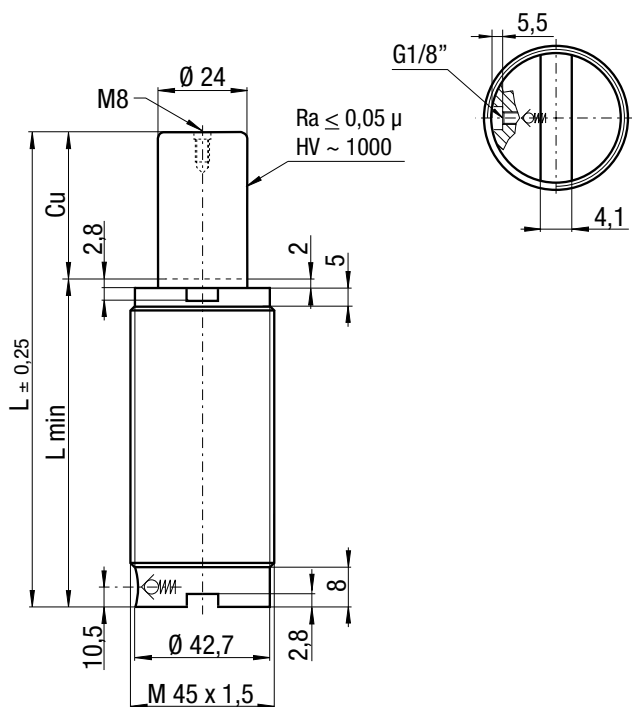

HF



(10) HF 700-050-A

ORDER (10) HF 700-050-A-N



Fixings

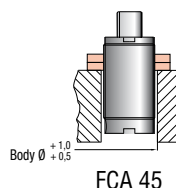

FCA 45

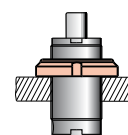

GM 45

Max. Speed
1,8 m/s

°F 32
176

°C 0
80



P max
150 bar
2175 psi

P min
20 bar
290 psi

S
4,52
cm²



Maintenance kit
39BMH00700A

Technical specifications

Code	Cu mm	L mm	Lmin mm	Fo at 150 bar/+20 °C daN (±5%)	Vo cm ³	connecting hole G1/8" Jic 37° hose Minimess hose	Kg
HF 700 - 013 - A	12,7	110,4	97,7	680	31	HF 700 - 013 - A - N	~0,92
HF 700 - 025 - A	25	135	110	680	46	HF 700 - 025 - A - N	~1,03
HF 700 - 038 - A	38	161	123	680	62	HF 700 - 038 - A - N	~1,13
HF 700 - 050 - A	50	185	135	680	76	HF 700 - 050 - A - N	~1,24
HF 700 - 063 - A	63,5	212	148,5	680	93	HF 700 - 063 - A - N	~1,33
HF 700 - 080 - A	80	245	165	680	113	HF 700 - 080 - A - N	~1,46
HF 700 - 100 - A	100	285	185	680	137	HF 700 - 100 - A - N	~1,70
HF 700 - 125 - A	125	335	210	680	167	HF 700 - 125 - A - N	~1,78
HF 700 - 160 - A	160	405	245	680	210	HF 700 - 160 - A - N	~1,92

Info pg. 229

H 1000

PEO
97/23/EC



ISO Standard, forza potenziata - ISO Standard, high force - Standard ISO, erhöhte Leistung - Standard ISO, force majorée - ISO Standard, fuerza potenciada - Norma ISO, força permitida

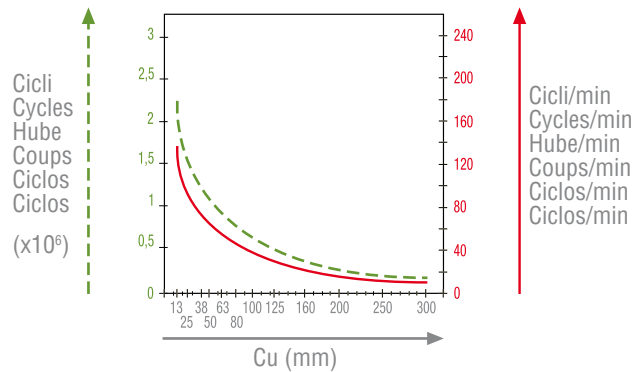
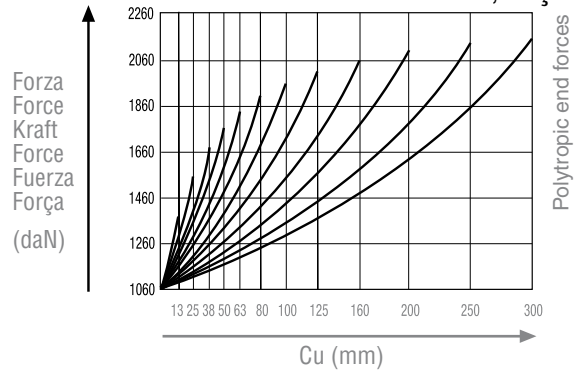
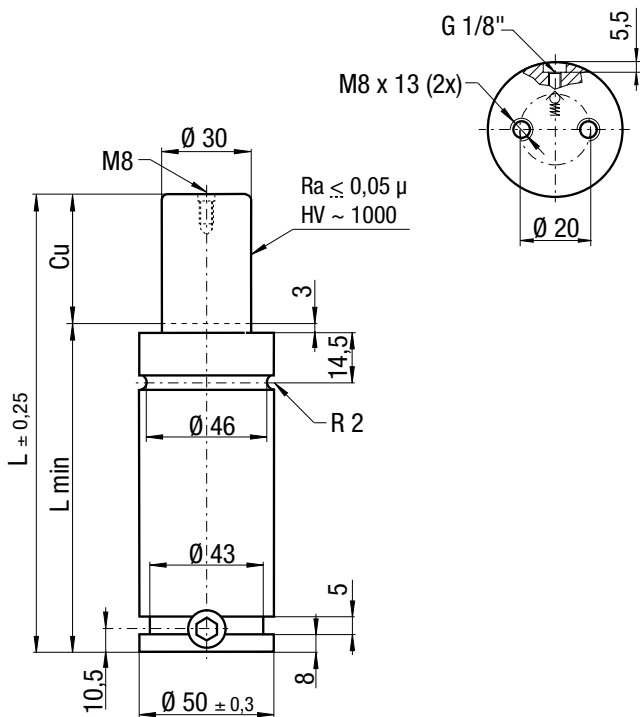

(10) H 1000-050-A
ORDER (10) H 1000-050-A-N

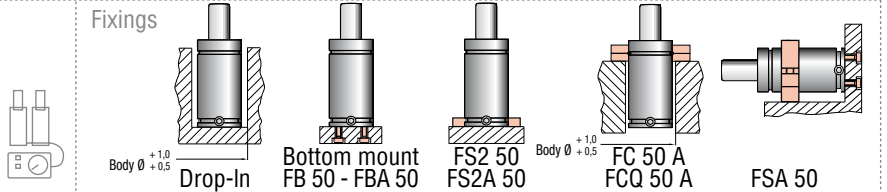

Max. Speed 1,8 m/s	°F 32 176	°C 0 80	N ₂	P max 150 bar 2175 psi	P min 20 bar 290 psi	S 7,07 cm ²		Maintenance kit 39BMH01000A
------------------------------	------------------------	----------------------	----------------	-------------------------------------	-----------------------------------	-------------------------------------	--	---------------------------------------

Technical specifications

Code	Cu mm	L mm	Lmin mm	F ₀ at 150 bar/+20 °C daN (±5%)	V ₀ cm ³	connecting hole G1/8" Jic 37° hose Minimess hose	Kg
H 1000 - 013 - A	12,7	120,4	107,7	1060	52	H 1000 - 013 - A - N	~1,35
H 1000 - 025 - A	25	145	120	1060	72	H 1000 - 025 - A - N	~1,44
H 1000 - 038 - A	38	171	133	1060	93	H 1000 - 038 - A - N	~1,59
H 1000 - 050 - A	50	195	145	1060	113	H 1000 - 050 - A - N	~1,68
H 1000 - 063 - A	63,5	222	158,5	1060	135	H 1000 - 063 - A - N	~1,83
H 1000 - 080 - A	80	255	175	1060	162	H 1000 - 080 - A - N	~1,99
H 1000 - 100 - A	100	295	195	1060	195	H 1000 - 100 - A - N	~2,19
H 1000 - 125 - A	125	345	220	1060	236	H 1000 - 125 - A - N	~2,43
H 1000 - 160 - A	160	415	255	1060	293	H 1000 - 160 - A - N	~2,77
H 1000 - 200 - A	200	495	295	1060	359	H 1000 - 200 - A - N	~3,16
H 1000 - 250 - A	250	595	345	1060	440	H 1000 - 250 - A - N	~3,64
H 1000 - 300 - A	300	695	395	1060	522	H 1000 - 300 - A - N	~4,13

Info pg. 229

ISO Standard, forza potenziata - ISO Standard, high force - Standard ISO,
erhöhte Leistung - Standard ISO, force majorée - ISO Standard, fuerza potenciada -
Norma ISO, força permitida

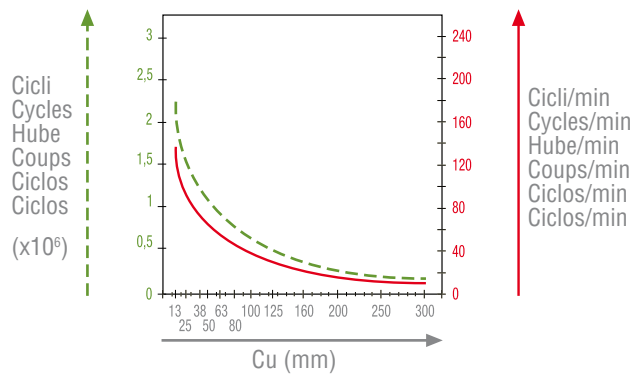
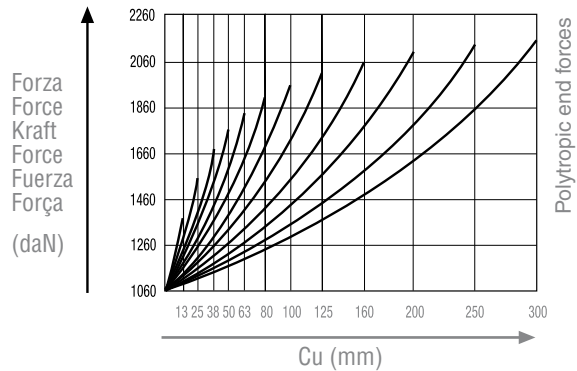
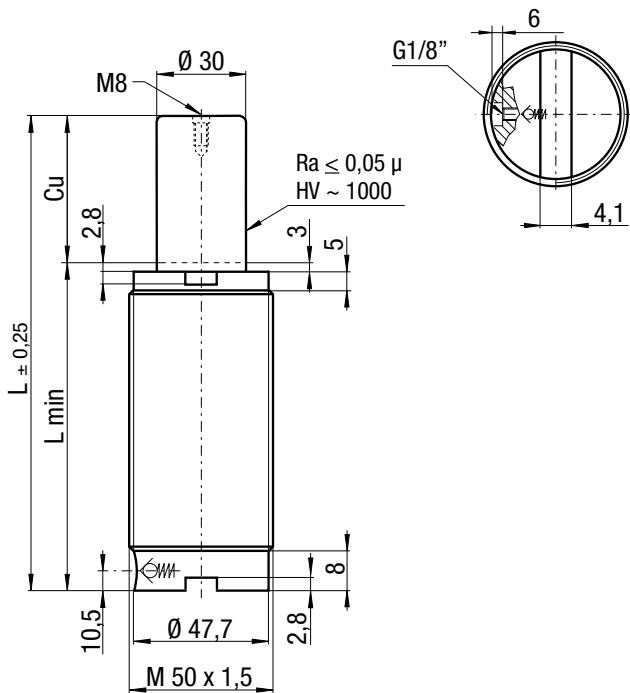

HF

(10) HF 1000-050-A
ORDER (10) HF 1000-050-A-N



Fixings

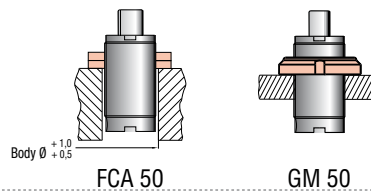

Max. Speed 1,8 m/s	°F 32 176	°C 0 80	N ₂	P max 150 bar 2175 psi	P min 20 bar 290 psi	S 7,07 cm ²		Maintenance kit 39BMH01000A
------------------------------	------------------------	----------------------	----------------	-------------------------------------	-----------------------------------	-------------------------------------	--	---------------------------------------

Technical specifications

Code	Cu mm	L mm	Lmin mm	Fo at 150 bar/+20 °C daN (±5%)	Vo cm ³	connecting hole G1/8" Jic 37° hose Minimess hose	Kg
HF 1000 - 013 - A	12,7	120,4	107,7	1060	52	HF 1000 - 013 - A - N	~1,24
HF 1000 - 025 - A	25	145	120	1060	72	HF 1000 - 025 - A - N	~1,35
HF 1000 - 038 - A	38	171	133	1060	93	HF 1000 - 038 - A - N	~1,41
HF 1000 - 050 - A	50	195	145	1060	113	HF 1000 - 050 - A - N	~1,59
HF 1000 - 063 - A	63,5	222	158,5	1060	135	HF 1000 - 063 - A - N	~1,72
HF 1000 - 080 - A	80	255	175	1060	162	HF 1000 - 080 - A - N	~1,89
HF 1000 - 100 - A	100	295	195	1060	195	HF 1000 - 100 - A - N	~2,15
HF 1000 - 125 - A	125	345	220	1060	236	HF 1000 - 125 - A - N	~2,40
HF 1000 - 160 - A	160	415	255	1060	293	HF 1000 - 160 - A - N	~2,63
HF 1000 - 200 - A	200	495	295	1060	359	HF 1000 - 200 - A - N	~3,09
HF 1000 - 250 - A	250	595	345	1060	440	HF 1000 - 250 - A - N	~3,60
HF 1000 - 300 - A	300	695	395	1060	522	HF 1000 - 300 - A - N	~4,08

Info pg. 229

H 2400

PEO
97/23/EC



ISO Standard, forza potenziata - ISO Standard, high force - Standard ISO, erhöhte Leistung - Standard ISO, force majorée - ISO Standard, fuerza potenciada - Norma ISO, forța permitida

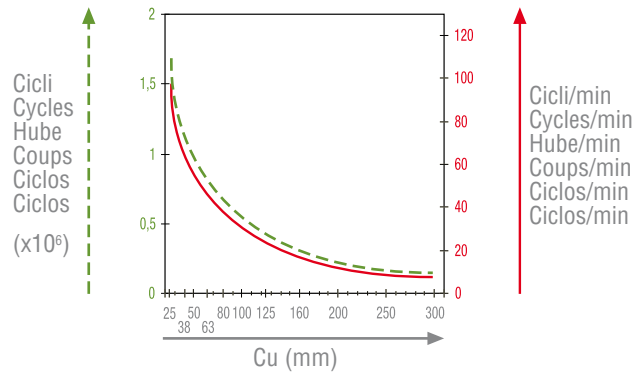
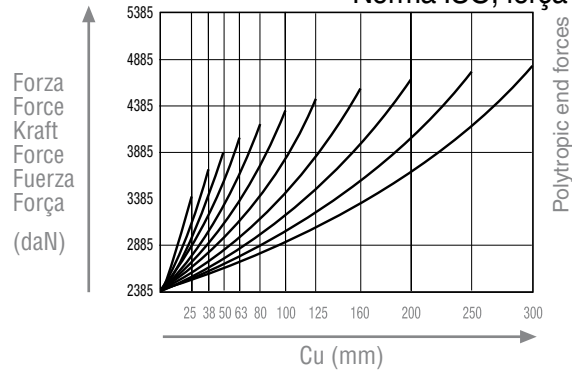
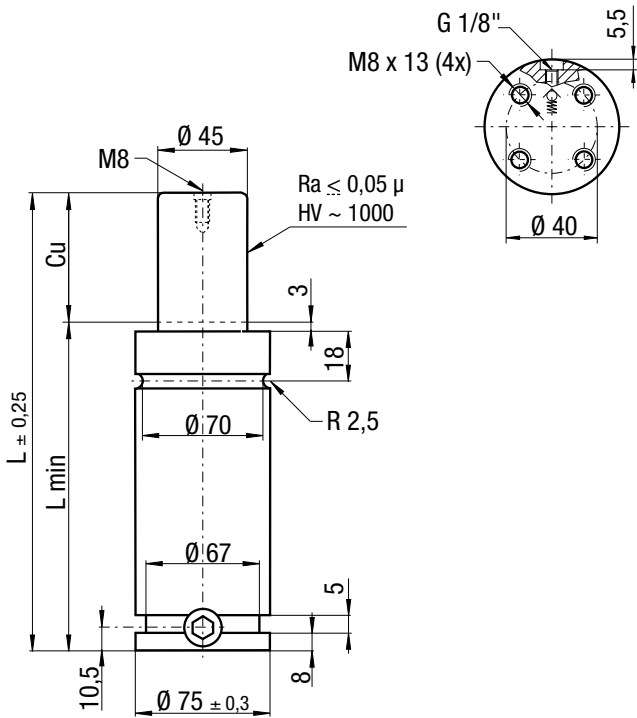

(10) H 2400-050-A
ORDER (10) H 2400-050-A-N

Fixings: Drop-In, Bottom mount (FB 75 - FBA 75), FS2 75 (FS2A 75), FC 75 A (FCQ 75 A), FSA 75

Max. Speed 1,8 m/s	°F 32 176	°C 0 80	N ₂	P max 150 bar 2175 psi	P min 20 bar 290 psi	S 15,9 cm ²		Maintenance kit 39BMH02400A
------------------------------	------------------------	----------------------	----------------	-------------------------------------	-----------------------------------	-------------------------------------	--	---------------------------------------

Technical specifications

Code	Cu mm	L mm	Lmin mm	F ₀ at 150 bar/+20 °C daN (±5%)	V ₀ cm ³	connecting hole G1/8" Jic 37° hose Minimess hose	Kg
H 2400 - 025 - A	25	160	135	2385	174	H 2400 - 025 - A - N	~3,70
H 2400 - 038 - A	38	186	148	2385	222	H 2400 - 038 - A - N	~3,96
H 2400 - 050 - A	50	210	160	2385	266	H 2400 - 050 - A - N	~4,21
H 2400 - 063 - A	63,5	237	173,5	2385	316	H 2400 - 063 - A - N	~4,50
H 2400 - 080 - A	80	270	190	2385	377	H 2400 - 080 - A - N	~4,81
H 2400 - 100 - A	100	310	210	2385	451	H 2400 - 100 - A - N	~5,23
H 2400 - 125 - A	125	360	235	2385	543	H 2400 - 125 - A - N	~5,67
H 2400 - 160 - A	160	430	270	2385	672	H 2400 - 160 - A - N	~6,48
H 2400 - 200 - A	200	510	310	2385	819	H 2400 - 200 - A - N	~7,49
H 2400 - 250 - A	250	610	360	2385	1003	H 2400 - 250 - A - N	~9,39
H 2400 - 300 - A	300	710	410	2385	1187	H 2400 - 300 - A - N	~11,23

Info pg. 229

ISO Standard, forza potenziata - ISO Standard, high force - Standard ISO,
 erhöhte Leistung - Standard ISO, force majorée - ISO Standard, fuerza potenciada -
 Norma ISO, força permitida

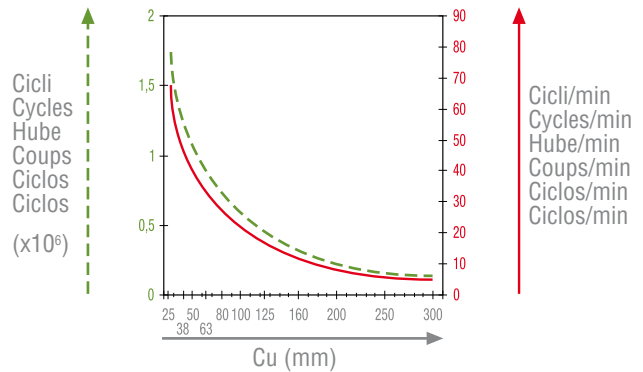
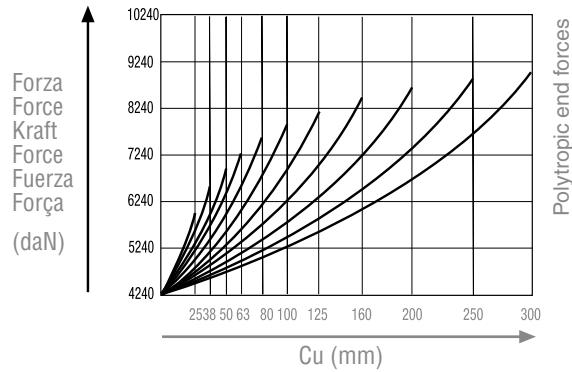
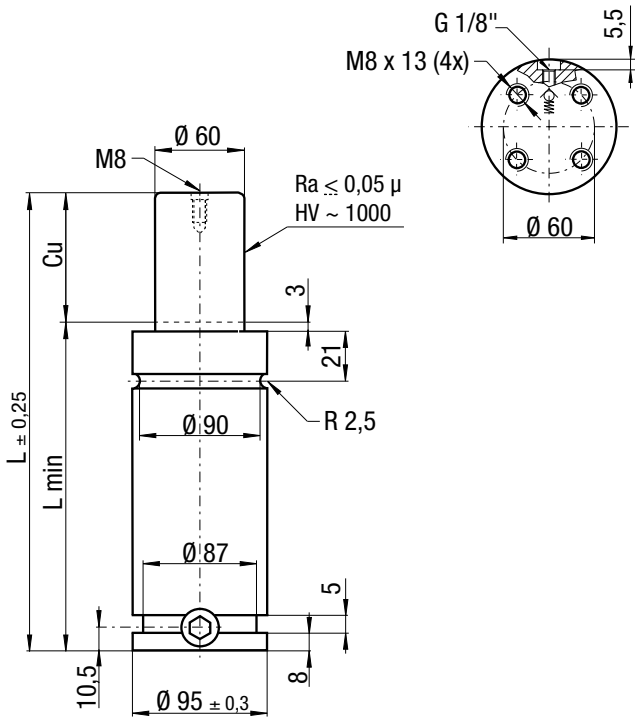

(10) H 4200-050-A
ORDER (10) H 4200-050-A-N

Fixings
 Drop-In, Bottom mount (FB 95 - FBA 95), FS2 95 / FS2A 95, FC 95 A / FCQ 95 A, FSA 95

Max. Speed 1,8 m/s	 °F 32 / 176 °C 0 / 80	 N ₂	P max 150 bar / 2175 psi	P min 20 bar / 290 psi	S 28,27 cm ²	 CAD	Maintenance kit 39BMH04200A
------------------------------	------------------------------	--------------------	------------------------------------	----------------------------------	-----------------------------------	---------	---------------------------------------

Technical specifications

Code	Cu mm	L mm	Lmin mm	Fo at 150 bar/+20 °C daN (±5%)	Vo cm ³	 connecting hole G1/8" Jic 37° hose Minimesh hose	 Kg
H 4200 - 025 - A	25	170	145	4240	310	H 4200 - 025 - A - N	~6,54
H 4200 - 038 - A	38	196	158	4240	389	H 4200 - 038 - A - N	~7,00
H 4200 - 050 - A	50	220	170	4240	462	H 4200 - 050 - A - N	~7,37
H 4200 - 063 - A	63,5	247	183,5	4240	544	H 4200 - 063 - A - N	~7,84
H 4200 - 080 - A	80	280	200	4240	644	H 4200 - 080 - A - N	~8,35
H 4200 - 100 - A	100	320	220	4240	765	H 4200 - 100 - A - N	~9,30
H 4200 - 125 - A	125	370	245	4240	916	H 4200 - 125 - A - N	~9,80
H 4200 - 160 - A	160	440	280	4240	1128	H 4200 - 160 - A - N	~10,5
H 4200 - 200 - A	200	520	320	4240	1371	H 4200 - 200 - A - N	~11,3
H 4200 - 250 - A	250	620	370	4240	1674	H 4200 - 250 - A - N	~12,3
H 4200 - 300 - A	300	720	420	4240	1974	H 4200 - 300 - A - N	~13,3

Info pg. 229

H 6600



ISO Standard, forza potenziata - ISO Standard, high force - Standard ISO, erhöhte Leistung - Standard ISO, force majorée - ISO Standard, fuerza potenciada - Norma ISO, força permitida

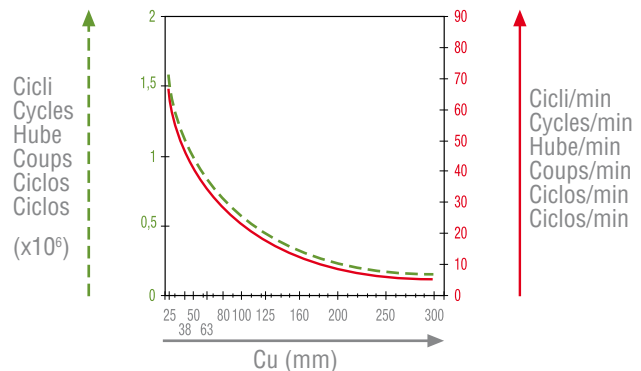
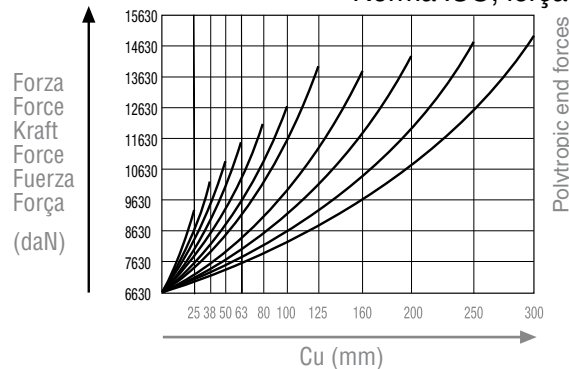
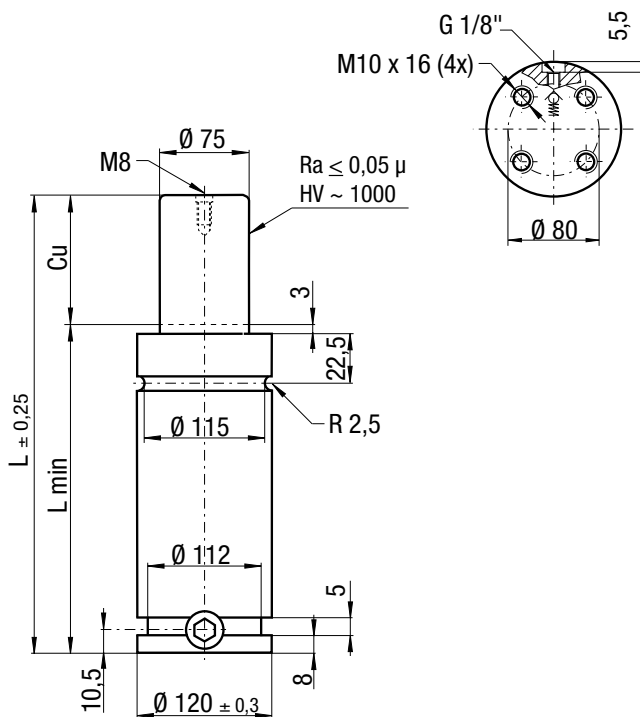

(10) H 6600-050-A
ORDER (10) H 6600-050-A-N

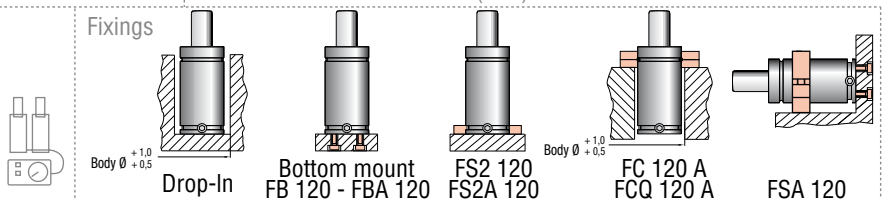

Max. Speed 1,8 m/s	°F 32 176	°C 0 80	N ₂	P max 150 bar 2175 psi	P min 20 bar 290 psi	S 44,18 cm ²		Maintenance kit 39BMH06600A
------------------------------	------------------------	----------------------	----------------	-------------------------------------	-----------------------------------	--------------------------------------	--	---------------------------------------

Technical specifications

Code	Cu mm	L mm	Lmin mm	Fo at 150 bar/+20 °C daN (±5%)	Vo cm ³	connecting hole G1/8" Jic 37° hose Minimess hose	Kg
H 6600 - 025 - A	25	190	165	6630	476	H 6600 - 025 - A - N	~12,1
H 6600 - 038 - A	38	216	178	6630	593	H 6600 - 038 - A - N	~13,7
H 6600 - 050 - A	50	240	190	6630	702	H 6600 - 050 - A - N	~15,1
H 6600 - 063 - A	63,5	267	203,5	6630	824	H 6600 - 063 - A - N	~15,5
H 6600 - 080 - A	80	300	220	6630	974	H 6600 - 080 - A - N	~16,1
H 6600 - 100 - A	100	340	240	6630	1155	H 6600 - 100 - A - N	~17,5
H 6600 - 125 - A	125	390	265	6630	1381	H 6600 - 125 - A - N	~19,3
H 6600 - 160 - A	160	460	300	6630	1698	H 6600 - 160 - A - N	~21,8
H 6600 - 200 - A	200	540	340	6630	2060	H 6600 - 200 - A - N	~24,7
H 6600 - 250 - A	250	640	390	6630	2512	H 6600 - 250 - A - N	~28,3
H 6600 - 300 - A	300	740	440	6630	2969	H 6600 - 300 - A - N	~31,9

Info pg. 229

ISO Standard, forza potenziata - ISO Standard, high force - Standard ISO,
 erhöhte Leistung - Standard ISO, force majorée - ISO Standard, fuerza potenciada -
 Norma ISO, força permitida

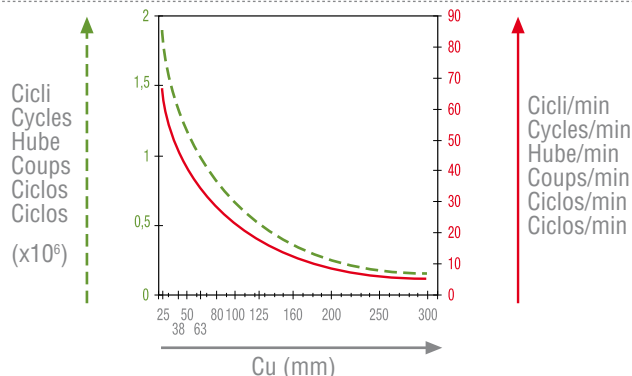
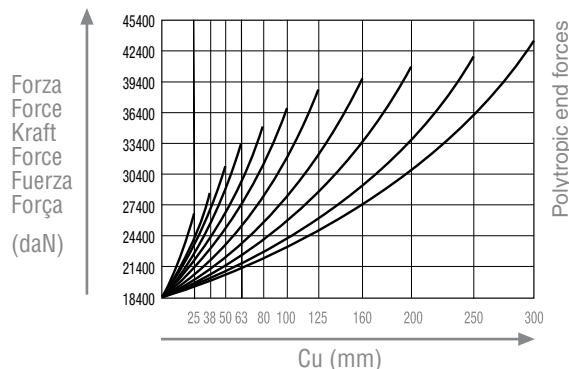
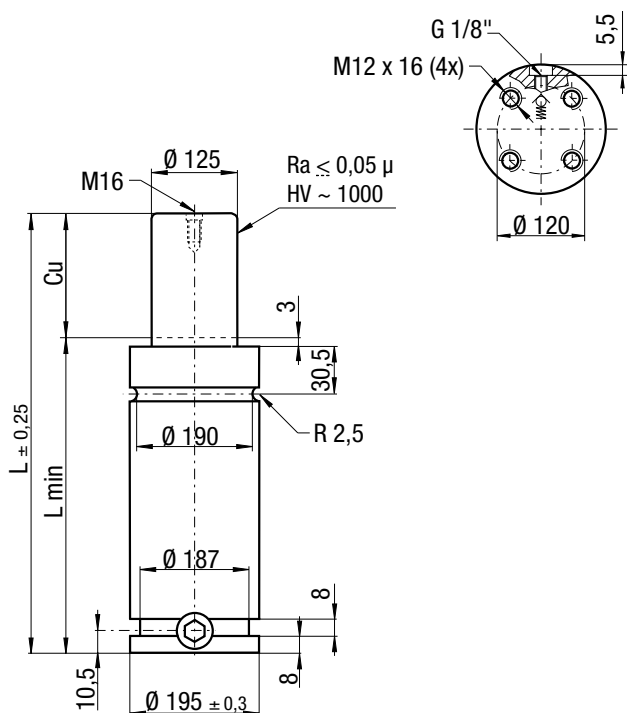

H
HF

(10) H 18500-050-A
ORDER (10) H 18500-050-A-N



Fixings

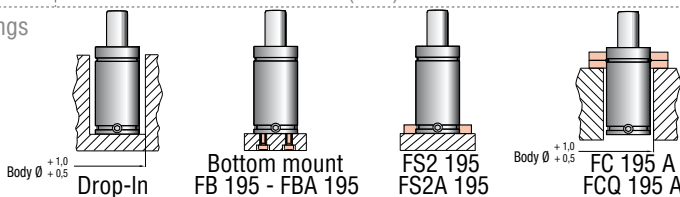

Max. Speed
1,8 m/s

°F 32
176
°C 0
80



P max
150 bar
2175 psi

P min
20 bar
290 psi

S
122,7
cm²



Maintenance kit
39BMH18500A

Technical specifications

Code	Cu mm	L mm	Lmin mm	Fo at 150 bar/+20 °C daN (±5%)	Vo cm ³	connecting hole G1/8" Jic 37° hose Minimess hose	Kg
H 18500 - 025 - A	25	210	185	18400	1658	H 18500 - 025 - A - N	~32,9
H 18500 - 038 - A	38	236	198	18400	2018	H 18500 - 038 - A - N	~34,4
H 18500 - 050 - A	50	260	210	18400	2351	H 18500 - 050 - A - N	~35,8
H 18500 - 063 - A	63,5	287	223,5	18400	2725	H 18500 - 063 - A - N	~37,3
H 18500 - 080 - A	80	320	240	18400	3182	H 18500 - 080 - A - N	~38,8
H 18500 - 100 - A	100	360	260	18400	3736	H 18500 - 100 - A - N	~41,5
H 18500 - 125 - A	125	410	285	18400	4429	H 18500 - 125 - A - N	~45,1
H 18500 - 160 - A	160	480	320	18400	5399	H 18500 - 160 - A - N	~48,3
H 18500 - 200 - A	200	560	360	18400	6507	H 18500 - 200 - A - N	~52,9
H 18500 - 250 - A	250	660	410	18400	7893	H 18500 - 250 - A - N	~57,7
H 18500 - 300 - A	300	760	460	18400	9278	H 18500 - 300 - A - N	~63,8

Info pg. 229