

Viti di spallamento a gambo rettificato
Hexagon socket head shoulder screws
Paßschrauben mit Innensechskant
Vis de retenue épaulées
Tornillo tope
Parafusio de corpo retificado

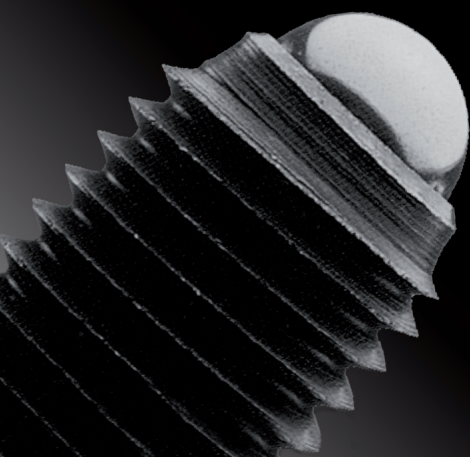

Viti con distanziale rettificato
Ground spacer sleeve shoulder screws
Schrauben mit Distanzrohr (geschliffen)
Vis avec entretoise rectifiée
Tornillo con espaciador retificado
Parafuso de corpo retificado com limitador de curso



Pressori a molla
Spring plungers
Drücker mit Feder
Poussoirs à ressort
Posicionador de bola
Posicionador de esfera



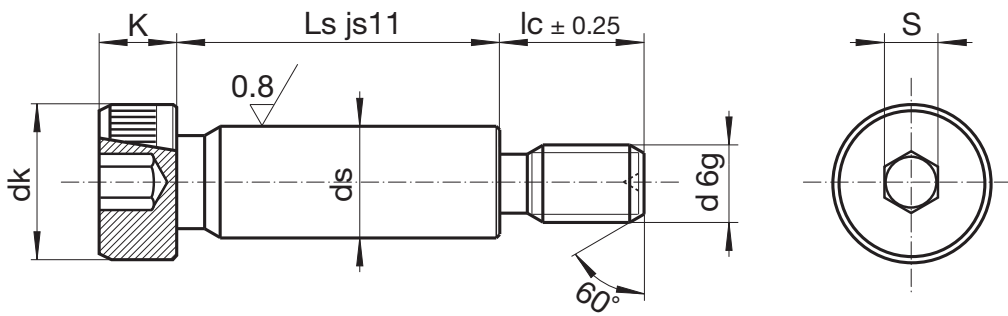

Ls (mm)	js11 (µm)
10 ÷ 18	± 55
18 ÷ 30	± 65
30 ÷ 50	± 80
50 ÷ 80	± 95
80 ÷ 120	± 110
120 ÷ 200	± 125

IT

Materiale: Acciaio legato alto resistenziale per bulloneria ISO 12.9.
Durezza: 37÷43 HRC.
Carico unitario di rottura a trazione: Rm = 1200 N/mm² min.
Carico unit. di scostam. dalla proporz.: Rp 0,2 = 1080 N/mm² min.
Carico unitario di resistenza al taglio: Tm = 720 N/mm² min.
Allungamento: A = 8% min. - **Resilienza:** KCU 15J min.

EN

Material: High grade alloy steel ISO 12.9.
Hardness: 37÷43 HRC.
Tensile strength: Rm = 1200 N/mm² min.
Yield strength: Rp 0,2 = 1080 N/mm² min.
Shear strength: Tm = 720 N/mm² min.
Elongation: A = 8% min. - **Impact test:** KCU 15J min.

DE

Werkstoff: Vergütungsstahl, vergütet auf 12.9 DIN/ISO 898.
Härte: 37÷43 HRC.
Zugfestigkeit: Rm = 1200 N/mm² min.
Dehngrenze: Rp 0,2 = 1080 N/mm² min.
Scherfestigkeit: Tm = 720 N/mm² min.
Verlängerung: A = 8% min. - **Kerbschlagzähigkeit:** KCU 15J min.

FR

Matériel: Acier à haute résistance pour vis ISO 12.9.
Dureté: 37÷43 HRC.
Résistance à la traction: Rm = 1200 N/mm² min.
Limite apparente d'élasticité: Rp 0,2 = 1080 N/mm² min.
Résistance au cisaillement: Tm = 720 N/mm² min.
Allongement: A = 8% min. - **Résilience:** KCU 15J min.

ES

Material: Acero alta resistencia ISO 12.9.
Dureza: 37÷43 HRC.
Resistencia a la tracción: Rm = 1200 N/mm².
Límite aparente de elasticidad: Rp 0,2 = 1080 N/mm² min.
Resistencia al corte: Tm = 720 N/mm² min.
Elongación: A = 8% min. - **Resiliencia:** KCU = 15J min.

PT

Material: Liga de aço ISO 12.9.
Dureza: 37÷43 HRC.
Carga de tensão: Rm = 1200 N/mm² min.
Carga de rotura: Rp 0,2 = 1080 N/mm² min.
Carga de desgaste: Tm = 720 N/mm² min.
Elasticidade: A = 8% min - **Teste ao impacto:** KCU = 15J min.

Dimensions [mm]

nom.	ds h8		d	dk	K	lc	S
	min.	max.					
5	4,982	5,000	M4	9,00	4,0	8,00	2
6	5,982	6,000	M5	10,22	4,5	9,50	3
8	7,978	8,000	M6	13,27	5,5	11,25	4
10	9,978	10,000	M8	16,27	7,0	13,25	5
12	11,973	12,000	M10	18,27	9,0	16,00	6
16	15,973	16,000	M12	24,33	11,0	18,40	8
20	19,967	20,000	M16	30,33	14,0	22,40	10
24	23,967	24,000	M20	36,39	16,0	27,40	12

Supplying range ✓

ds	d	Ls																				Pcs						
		10	12	15	16	20	25	30	35	40	45	50	55	60	65	70	75	80	90	100	110		120	140	160	180	200	
5	M4	✓	✓	✓	✓	✓	✓	✓	✓	✓	✓	✓	-	-	-	-	-	-	-	-	-	-	-	-	-	-	100	
6	M5	✓	✓	✓	✓	✓	✓	✓	✓	✓	✓	✓	✓	✓	✓	✓	-	✓	-	-	-	-	-	-	-	-	50	
8	M6	✓	✓	✓	✓	✓	✓	✓	✓	✓	✓	✓	✓	✓	✓	✓	-	✓	✓	✓	-	-	-	-	-	-	50	
10	M8	✓	✓	✓	✓	✓	✓	✓	✓	✓	✓	✓	✓	✓	✓	✓	-	✓	✓	✓	✓	✓	✓	-	-	-	50	
12	M10	-	-	-	-	-	-	-	-	-	-	-	-	-	-	-	-	-	-	-	-	-	✓	-	-	-	10	
		-	✓	✓	✓	✓	✓	✓	✓	✓	✓	✓	✓	✓	✓	✓	✓	-	✓	✓	✓	✓	✓	✓	-	-	-	25
16	M12	-	-	-	-	-	-	-	-	-	-	-	-	-	-	-	-	-	-	-	-	-	-	-	✓	✓	✓	10
		-	-	-	-	✓	✓	✓	✓	✓	✓	✓	✓	✓	✓	✓	✓	-	✓	✓	✓	✓	✓	✓	✓	-	-	25
20	M16	-	-	-	-	-	-	✓	✓	✓	✓	✓	✓	✓	✓	✓	✓	✓	✓	✓	✓	✓	✓	✓	✓	✓	10	
24	M20	-	-	-	-	-	-	-	-	✓	✓	✓	✓	✓	✓	✓	✓	✓	✓	✓	✓	✓	✓	✓	✓	✓	10	

HOW TO ORDER

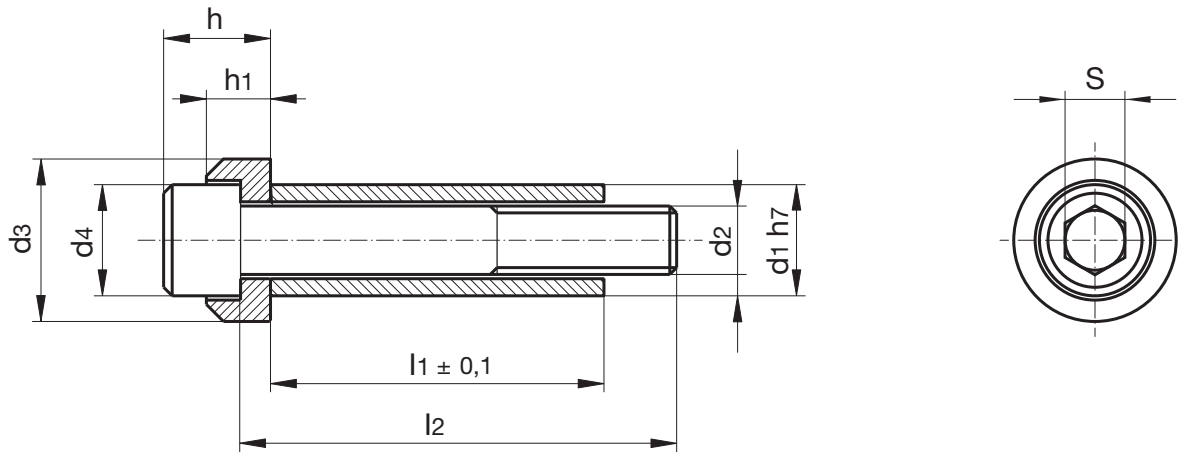

**IT**

Vite: Acciaio classe 12.9 UNI 5931 DIN 912.

Rondella: Acciaio trattato rinvenuto e brunito; resistenza 100 Kg/mm².

Distanziale: Acciaio trattato rinvenuto e rettificato; resistenza 120 - 140 Kg/mm².

EN

Cap screw: Steel class 12.9 UNI 5931 DIN 912.

Cup washer: Hardened and tempered steel, not ground; tensile strength 100 Kg/mm².

Spacer sleeve: Hardened, tempered and ground steel; tensile strength 120 - 140 Kg/mm².

DE

Innensechskant Schulterschraube: Stahl sorte 12.9 UNI 5931 DIN 912.

Scheibe für zylinderkopfschraube: Vergütungsstahl, nicht geschliffen; festigkeit 100 Kg/mm².

Distanzrohr: Vergütungsstahl, geschliffen; festigkeit 120 - 140 Kg/mm².

FR

Vis tête cylindrique à 6 pans creux: Acier qualité 12.9 UNI 5931 DIN 912.

Rondelle d'appui: Acier trempé; coefficient d' élasticité 100 Kg/mm².

Tube entretoise: Acier trempé, surface rectifiée; coefficient d'élasticité 120 - 140 Kg/mm².

ES

Tornillo: Acero calidad 12.9 UNI 5931 DIN 912.

Arandela: Acero tratado y pulido; resistencia 100 Kg/mm².

Distancial: Acero tratado y rectificado; resistencia 120 - 140 Kg/mm².

PT

Parafuso: Cabeça cilíndrica grade 12.9 UNI 5931 DIM 912.

Anilha de apoio: Aço temperado mas não rectificado; carga de tensão 100 Kg / mm².

Espaçador tubular: Aço temperado e rectificado; carga de tensão 120 - 140 Kg/ mm².

Dimensions [mm]

d1 h7	d2	d3	d4	h	h1	S
10	M6	15	10	10	5,5	5
12,5	M8	19	13	13	6,5	6
15	M10	23	16	15	7,5	8
17,5	M12	27	18	18	9,0	10
23	M16	34	24	24	11,0	14

Supplying range																				
d1	d2	l2																		 Pcs
10	M6	35	40	45	50	55	60	65	70	80	90	100	110	120	-	-	-	-	-	24
12,5	M8	-	-	45	50	55	60	65	70	80	90	100	110	120	-	-	-	-	-	24
15	M10	-	-	50	55	60	65	70	75	80	90	100	110	120	-	140	-	-	-	24
17,5	M12	-	-	-	-	60	65	70	80	90	100	110	120	130	140	150	170	-	-	24
23	M16	-	-	-	-	-	-	80	-	90	100	110	120	130	140	150	180	180	200	12
l1		20	25	30	35	40	45	50	55	60	70	80	90	100	110	120	140	150	160	

HOW TO ORDER

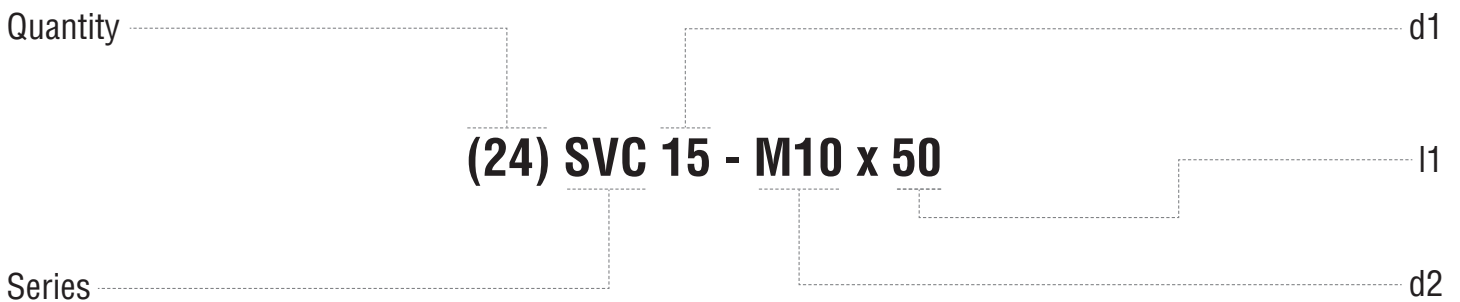

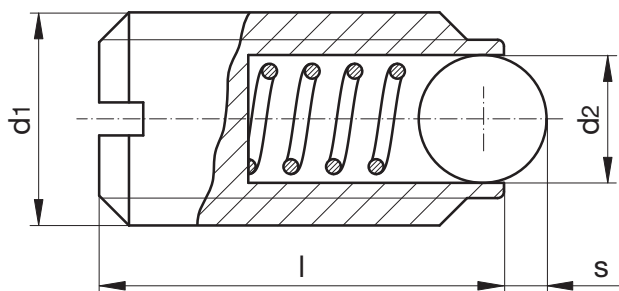

IT

Materiale: Acciaio classe 5.8.
Trattamento superficiale: Brunitura.
Sfera: Acciaio inox temprato e lucidato.

EN

Material: Steel class 5.8.
Surface treatment: Black oxidation.
Ball: Hardened and polished stainless steel.

DE

Material: Stahlsorte 5.8.
Oberflächenbehandlung: Brüniert.
Kugel: Aus rostfreiem stahl, gehärtet und poliert.

FR

Matière: Acier qualité 5.8.
Traitement de surface: Bruni.
Bille: Acier inox traité.

ES

Material: Acero clase 5.8.
Tratamiento superficial: Oxidación negro.
Bola: Acero inoxidable endurecido y pulido.

PT

Material: Aço classe 5.8.
Tratamento de superfície: Oxidação preta.
Bola: Aço inoxidável temperado e polido.

Supplying range

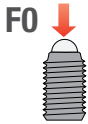
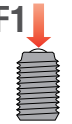
Part Number	d1	l	s	d2			
						N	N
		mm	mm	mm	g		
SSP M4	M4	9	0,8	2,5	0,5	6	12
SSP M5	M5	12	0,9	3,0	0,8	7	13
SSP M6	M6	14	1,0	3,5	1,7	9	15
SSP M8	M8	16	1,5	5,0	3,5	20	35
SSP M10	M10	19	2,0	6,0	6,0	25	45
SSP M12	M12	22	2,5	8,0	10,0	35	60
SSP M16	M16	24	3,5	10,0	22,5	65	110

HOW TO ORDER

Series d1

(20) SSP M8

Quantity



EUROPE

Headquarter

Special Springs S.r.l.
Via Nardi, 124/A
36060 Romano d'Ezzelino (VI) - ITALY
tel. +39 0424 539181
email: info@specialsprings.com
www.specialsprings.com

French Subsidiary

Special Springs France
Impasse de la Birbadière
49650 Allonnes - FRANCE
Ph. +33 (0)6 37 62 76 62
email: contact@specialsprings.fr
www.specialsprings.com

AMERICA

North American Subsidiary

Special Springs LLC
7707 Ronda Drive, Canton
Michigan 48187 - USA
Ph. +1 734.892.2324
email: info@specialspringsna.com
www.specialspringsna.com

South American Subsidiary

Special Springs do Brasil
Avenida dom Pedro I, 2156 - Vila Pires
09130-012 Santo André / SP - BRASIL
Ph. +55 11 2324 3545
email: comercial@specialsprings.com.br
www.specialsprings.com.br

ASIA

Indian Subsidiary

Global Special Springs pvt. Ltd.
Survay no. 69/2 - Chandarda, Tal. Kadi
Dist. Mehesana (Ahmedabad - Mehesana Highway)
Gujarat, 382705 - INDIA
Ph. +91 2764 273065
email: info@globalspecialsprings.com
www.specialsprings.com

Catalog code

9800K06200023

